



MADE IN THE USA



FORGED STEEL/V-GROOVE



STEEL/STAINLESS STEEL



CAST IRON/V-GROOVE

| | <u>PAGE</u> |
|---------------------------|-------------|
| Forged Steel | 260-261 |
| Ductile Iron | 262-263 |
| Cast Iron | 264-267 |
| Steel Wheels | 268-270 |
| Stainless Steel | 271 |

FORGED STEEL - FS

Capacity Up to 20,000 lbs.



Drop forged steel wheels are hot forged from carbon steel billets. The forging process improves grain flow, enhances ductility and tensile strength. Suitable for high capacity, abusive applications. Forged steel is 64,000 psi tensile strength.

Features:

- **Wheel Face:** Flat with rounded edges.
- **Finish:** Clear coat enamel.
- **Temperature Range:** Up to 800°F.
- **Hardness:** Rockwell 80 B.

Wheel Options

- **Note:** Select bearings featured are recommended for standard applications. For special applications or alternate bearings, consult Acorn™.
- For customization & special application options, please consult Acorn™.

FORGED STEEL/ LARGE BORE - FH

Capacity Up to 20,000 lbs.

| Dia. (inch) | Width (inch) | Capacity (lbs) | Hub Length (inch) | Bore (inch) | Bearing (inch) | Wt. (lbs) | Part Number* |
|-------------|--------------|----------------|-------------------|-------------|----------------|-----------|--------------|
| 6 | 2 | 1500 | 2-3/16 | 1-3/16 | 1/2 | 6-1/4 | FS0620108 |
| 6 | 2 | 1500 | 2-3/16 | 1-3/16 | 5/8 | 6-1/4 | FS0620110 |
| 6 | 2 | 1500 | 2-3/16 | 1-3/16 | 3/4 | 6-1/4 | FS0620112 |
| 6 | 2 | 2500 | 2-7/16 | 1-3/8 | 1/2 | 6-1/4 | FS0620908 |
| 6 | 2 | 2500 | 2-7/16 | 1-7/8 | 3/4 | 6-1/4 | FS0620912 |
| 6 | 3 | 6000 | 3-1/4 | 2-7/16 | 1-1/4 | 20-1/4 | FS0630120 |
| 6 | 3 | 6000 | 3-1/4 | 2-7/16 | 1-1/2 | 20-1/4 | FS0630124 |
| 6 | 3 | 10,000 | 3-1/4 | 2-7/16 | 1 | 19-3/4 | FS0630916 |
| 6 | 3 | 10,000 | 3-1/4 | 2-7/16 | 1-1/8 | 19-3/4 | FS0630918 |
| 6 | 3 | 10,000 | 3-1/4 | 2-7/16 | 1-1/4 | 19-3/4 | FS0630920 |
| 8 | 3 | 4500 | 3-1/4 | 1-15/16 | 1 | 18-1/4 | FS0830116 |
| 8 | 3 | 4500 | 3-1/4 | 1-15/16 | 1-1/4 | 18-1/4 | FS0830120 |
| 8 | 3 | 5500 | 3-1/2 | 1-15/16 | 3/4 | 18-1/4 | FS0830912 |
| 8 | 3 | 5500 | 3-1/2 | 2-1/4 | 1 | 18-1/4 | FS0830916 |
| 8 | 4 | 8350 | 4-1/4 | 2-7/16 | 1-1/4 | 35-1/2 | FS0840120 |
| 8 | 4 | 8350 | 4-1/4 | 2-7/16 | 1-1/2 | 35-1/2 | FS0840124 |
| 8 | 4 | 10,000 | 4-1/2 | 2-7/16 | 1 | 36-1/2 | FS0840916 |
| 8 | 4 | 10,000 | 4-1/2 | 2-7/16 | 1-1/8 | 36-1/2 | FS0840918 |
| 8 | 4 | 10,000 | 4-1/2 | 2-7/16 | 1-1/4 | 36-1/2 | FS0840920 |
| 10 | 3 | 5000 | 3-1/4 | 1-15/16 | 1 | 27-3/4 | FS1030116 |
| 10 | 3 | 5000 | 3-1/4 | 1-15/16 | 1-1/4 | 27-3/4 | FS1030120 |
| 10 | 3 | 6000 | 3-1/2 | 1-15/16 | 3/4 | 27-1/2 | FS1030912 |
| 10 | 4 | 8350 | 4-1/4 | 2-7/16 | 1-1/4 | 48 | FS1040120 |
| 10 | 4 | 8350 | 4-1/4 | 2-7/16 | 1-1/2 | 48 | FS1040124 |
| 10 | 4 | 10,000 | 4-1/2 | 2-7/16 | 1 | 47-1/4 | FS1040916 |
| 10 | 4 | 10,000 | 4-1/2 | 2-7/16 | 1-1/8 | 47-1/4 | FS1040918 |
| 10 | 4 | 10,000 | 4-1/2 | 2-7/16 | 1-1/4 | 47-1/4 | FS1040920 |

*R = Roller Bearing, P = Precision Ball Bearing, T = Tapered Roller Bearing

| Dia. (inch) | Width (inch) | Capacity (lbs) | Hub Length (inch) | Bore (inch) | Bearing (inch) | Wt. (lbs) | Part Number* |
|-------------|--------------|----------------|-------------------|-------------|----------------|-----------|--------------|
| 6 | 3 | 17000 | 3-1/2 | 2-7/16 | 1-1/4 | 22-1/4 | FH0650920 |
| 6 | 3 | 17000 | 3-1/2 | 2-7/16 | 1-1/2 | 22-1/4 | FH0650924 |
| 8 | 3 | 6500 | 3-1/4 | 2-7/16 | 1-1/4 | 34 | FH0850120 |
| 8 | 4 | 20000 | 4-1/2 | 3-1/8 | 1-1/4 | 34 | FH0850920 |
| 8 | 4 | 20000 | 4-1/2 | 3-1/8 | 1-1/2 | 34 | FH0850924 |
| 10 | 3 | 6000 | 3-1/4 | 2-7/16 | 1-1/4 | 37-1/4 | FH01050120 |
| 10 | 3 | 6000 | 3-1/4 | 2-7/16 | 1-1/2 | 37-1/4 | FH01050124 |
| 10 | 3 | 6500 | 3-1/2 | 2-7/16 | 1 | 37 | FH01050916 |
| 10 | 3 | 6500 | 3-1/2 | 2.33 | 1-1/4 | 37 | FH01050920 |
| 10 | 4 | 20000 | 4-1/2 | 3-1/8 | 1-1/4 | 46-1/4 | FH01070920 |
| 10 | 4 | 20000 | 4-1/2 | 3-1/8 | 1-1/2 | 46-1/4 | FH01070924 |

FORGED STEEL/V-GROOVE

FORGED STEEL/ V-GROOVE - VF/VH

Capacity Up to 20,000 lbs.

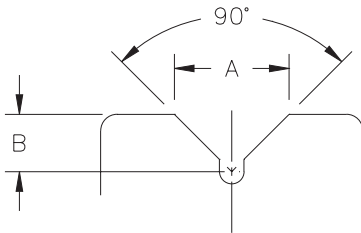

Wheel face and V-groove are machined from drop forged steel. A relief groove at the base of the “V” tends to equalize the load to each face of the angle track when in operation. Wheel face and bore are machined for concentricity to proper tracking. These wheels can be used not only on a track but flat surfaces as well. VH wheels feature a larger bore for greater capacity.

Please note: Track alignment is critical when utilizing V-groove wheels.

Features

- **Wheel Face:** V-groove .
- **Finish:** Clear.

Wheel Options

- **Note:** Select bearings featured are recommended for standard applications.
- For customization & special application options, consult Acorn™.

| Wheel Dia. (inch) | Tread Width (inch) | Capacity (lbs) | Hub Length (inch) | Bore ID (inch) | Bearing ID (inch) | Groove Width “A” | Groove Depth “B” | Approx. Weight (lbs) | Part Number* |
|-------------------|--------------------|----------------|-------------------|----------------|-------------------|------------------|------------------|----------------------|--------------|
| 6 | 3 | 6000 | 3-1/4 | 2-7/16 | 1-1/4 | 1-3/8 | 11/16 | 20-1/4 | VF0630120 |
| 6 | 3 | 6000 | 3-1/4 | 2-7/16 | 1-1/2 | 1-3/8 | 11/16 | 20-1/4 | VF0630124 |
| 6 | 3 | 6500 | 3-1/2 | 2-7/16 | 1 1-3/8 | | 11/16 | 19-3/4 | VF0630916 |
| 6 | 3 | 6500 | 3-1/2 | 2-7/16 | 1-1/4 | 1-3/8 | 11/16 | 19-3/4 | VF0630920 |
| 6 | 3 | 10000 | 3-1/2 | 3-1/8 | 1-1/4 | 1-3/8 | 11/16 | 22 | VH0630920 |
| 6 | 3 | 10000 | 3-1/2 | 3-1/8 | 1-1/2 | 1-3/8 | 11/16 | 22 | VH0630924 |
| 8 | 3 | 6000 | 3-1/4 | 1-15/16 | 1 | 7/8 | 7/16 | 30 | VF0830116 |
| 8 | 4 | 8350 | 4-1/4 | 2-7/16 | 1-1/4 | 1-3/4 | 7/8 | 21-3/4 | VF0840120 |
| 8 | 4 | 8350 | 4-1/4 | 2-7/16 | 1-1/2 | 1-3/4 | 7/8 | 21-3/4 | VF0840124 |
| 8 | 4 | 10000 | 4-1/2 | 2-7/16 | 1 | 1-3/4 | 7/8 | 21 | VF0840916 |
| 8 | 4 | 10000 | 4-1/2 | 2-7/16 | 1-1/4 | 1-3/4 | 7/8 | 21 | VF0840920 |
| 8 | 4 | 15000 | 4-1/2 | 3-1/8 | 1-1/4 | 1-3/4 | 7/8 | 27-1/2 | VH0840920 |
| 8 | 4 | 15000 | 4-1/2 | 3-1/8 | 1-1/2 | 1-3/4 | 7/8 | 27-1/2 | VH0840924 |
| 10 | 3 | 6000 | 3-1/4 | 2-7/16 | 1-1/4 | 1-3/8 | 11/16 | 37-1/2 | VH1030120 |
| 10 | 3 | 6000 | 3-1/4 | 2-7/16 | 1-1/2 | 1-3/8 | 11/16 | 37-1/2 | VH1030124 |
| 10 | 3 | 6000 | 3-1/2 | 2-7/16 | 1 | 1-3/8 | 11/16 | 37 | VH1030916 |
| 10 | 3 | 6000 | 3-1/2 | 2-7/16 | 1-1/4 | 1-3/8 | 11/16 | 37 | VH1030920 |
| 10 | 3 | 5000 | 3-1/4 | 1-15/16 | 1 | 1-3/8 | 11/16 | 27-3/4 | VF1030116 |
| 10 | 3 | 5000 | 3-1/4 | 1-15/16 | 1-1/4 | 1-3/8 | 11/16 | 27-3/4 | VF1030120 |
| 10 | 4 | 8350 | 4-1/4 | 2-7/16 | 1-1/4 | 1-3/4 | 7/8 | 48 | VH1040120 |
| 10 | 4 | 8350 | 4-1/4 | 2-7/16 | 1-1/2 | 1-3/4 | 7/8 | 48 | VH1040124 |
| 10 | 4 | 10000 | 4-1/2 | 2-7/16 | 1 | 1-3/4 | 7/8 | 47-1/4 | VH1040916 |
| 10 | 4 | 10000 | 4-1/2 | 2-7/16 | 1-1/4 | 1-3/4 | 7/8 | 47-1/4 | VH1040920 |
| 10 | 4 | 15000 | 4-1/2 | 3-1/8 | 1-1/4 | 1-3/4 | 7/8 | 46-1/4 | VH1040920 |
| 10 | 4 | 15000 | 4-1/2 | 3-1/8 | 1-1/2 | 1-3/4 | 7/8 | 46-1/4 | VH1040924 |

* R = Roller Bearing, P = Precision Ball Bearing, T = Tapered Roller Bearing

DUCTILE IRON

DUCTILE IRON/ FLAT TREAD - FM

Capacity Up to 6000 lbs.



Features

- **Wheel Face:** FM flat tread design, FR full radius tread design.
- **Finish:** Black painted.

Temperature Range:

Up to +800°F.

Tensile Strength:

65K PSI.

| Dia. (inch) | Width (inch) | Capacity (lbs) | Hub Length (inch) | Bore (inch) | Bearing (inch) | Wt. (lbs) | Part Number Plain Bore (00) | Part Number Roller Bearing (01) | Part Number Tapered Roller (09) |
|-------------|--------------|----------------|-------------------|-------------|----------------|-----------|-----------------------------|---------------------------------|---------------------------------|
| 5 | 2 | 1500 | 2-3/16 | 1-3/16 | 3/4 | 6 | FM0520019 | FM0520112 | |
| 5 | 2 | 1500 | 2-3/16 | 1-3/16 | 1/2 | 6 | | | FM0520908 |
| 6 | 2 | 1500 | 2-3/16 | 1-3/16 | 3/4 | 7-1/2 | FM0620019 | FM0620112 | |
| 6 | 2 | 2000 | 2-3/16 | 1-3/16 | 1/2 | 7-1/2 | | | FM0620908 |
| 6 | 3 | 6000 | 3-1/4 | 1-15/16 | 1-1/4 | 11-1/2 | FM0640013 | FM0640120 | |
| 6 | 3 | 6000 | 3-1/4 | 1-15/16 | 1-1/4 | 11-1/2 | | | FM0640912 |
| 8 | 2 | 2000 | 2-3/16 | 1-3/16 | 3/4 | 11 | FM0820019 | FM0820112 | |
| 8 | 2 | 2000 | 2-3/16 | 1-3/16 | 1/2 | 11 | | | FM0820908 |
| 8 | 3 | 6000 | 3-1/4 | 1-15/16 | 1 | 15-1/2 | FM08350031 | FM0830116 | |
| 8 | 3 | 6000 | 3-1/4 | 1-15/16 | 3/4 | 15-1/2 | | | FM0830912 |
| 10 | 3 | 6000 | 3-1/4 | 1-15/16 | 1-1/4 | 20-1/2 | FM1030031 | FM1030120 | |
| 10 | 3 | 6000 | 3-1/4 | 1-15/16 | 3/4 | 20-1/2 | | | FM1030912 |

DUCTILE IRON/ CROWN TREAD - FR

Capacity Up to 6000 lbs.



| Dia. (inch) | Width (inch) | Capacity (lbs) | Hub Length (inch) | Bore (inch) | Bearing (inch) | Wt. (lbs) | Part Number Plain Bore (00) | Part Number Roller Bearing (01) | Part Number Tapered Roller (09) |
|-------------|--------------|----------------|-------------------|-------------|----------------|-----------|-----------------------------|---------------------------------|---------------------------------|
| 5 | 2 | 1500 | 2-3/16 | 1-3/16 | 3/4 | 6 | FR0520019 | FR0520112 | |
| 5 | 2 | 1500 | 2-7/16 | 1-3/8 | 1/2 | 6 | | | FR0520908 |
| 6 | 2 | 2000 | 2-3/16 | 1-3/16 | 3/4 | 7-1/2 | FR0620019 | FR0620112 | |
| 6 | 2 | 2000 | 2-7/16 | 1-3/8 | 1/2 | 7-1/2 | | | FR0620908 |
| 6 | 3 | 6000 | 3-1/4 | 1-15/16 | 1-1/4 | 11-1/2 | FR0630013 | FR0630120 | |
| 6 | 3 | 6000 | 3-1/2 | 1-15/16 | 3/4 | 11-1/2 | | | FR0630912 |
| 8 | 2 | 1500 | 2-3/16 | 1-3/16 | 1-3/16 | 11 | FR0820019 | FR0820112 | |
| 8 | 2 | 2000 | 2-7/16 | 1-3/8 | 1/2 | 11 | | | FR0820908 |
| 8 | 3 | 5000 | 3-1/4 | 1-15/16 | 1-1/4 | 15-1/2 | FR0830031 | FR0830116 | |
| 8 | 3 | 6000 | 3-1/2 | 1-15/16 | 3/4 | 15-1/2 | | | FR0830912 |
| 10 | 3 | 5000 | 3-1/4 | 1-15/16 | 1-1/4 | 20-1/2 | FR1030031 | FR1030120 | |
| 10 | 3 | 6000 | 3-1/2 | 1-15/16 | 3/4 | 20-1/2 | | | FR1030912 |

DUCTILE IRON/ V-GROOVE - VM

Capacity Up to 6000 lbs.



V-Groove Measurements

- A: 6" & 8" wheel diameters = 7/8" wide
10" wheel diameters = 1-3/8" wide
- B: 6" & 8" wheel diameters = 7/16" tall
10" wheel diameters = 11/16" tall

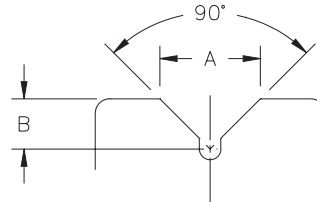

| Wheel Dia. (inch) | Tread Width (inch) | Capacity (lbs) | Hub Length (inch) | Bore ID (inch) | Bearing ID (inch) | Groove Width "A" | Groove Depth "B" | Approx. Weight (lbs) | Part Number Roller Bearing (01) | Part Number Tapered Roller (09) |
|-------------------|--------------------|----------------|-------------------|----------------|-------------------|------------------|------------------|----------------------|---------------------------------|---------------------------------|
| 6 | 3 | 5000 | 3-1/4 | 1-15/16 | 1 | 7/8 | 7/16 | 10-1/2 | VM0630116 | |
| 6 | 3 | 5000 | 3-1/4 | 1-15/16 | 1-1/4 | 7/8 | 7/16 | 10-1/2 | VM0630120 | |
| 6 | 3 | 5000 | 3-1/2 | 1-15/16 | 3/4 | 7/8 | 7/16 | 10-1/2 | | VM0630912 |
| 8 | 3 | 5000 | 3-1/4 | 1-15/16 | 1 | 7/8 | 7/16 | 16-1/2 | VM0830116 | |
| 8 | 3 | 5000 | 3-1/4 | 1-15/16 | 1-1/4 | 7/8 | 7/16 | 16-1/2 | VM0830120 | |
| 8 | 3 | 5000 | 3-1/2 | 1-15/16 | 3/4 | 7/8 | 7/16 | 16-1/2 | | VM0830912 |
| 8 | 3 | 5000 | 3-1/2 | 1-15/16 | 1 | 7/8 | 7/16 | 16-1/2 | | VM0830916 |
| 10 | 3 | 6000 | 3-1/4 | 1-15/16 | 1 | 1-3/8 | 11/16 | 26 | VM1030116 | |
| 10 | 3 | 6000 | 3-1/4 | 1-15/16 | 1-1/4 | 1-3/8 | 11/16 | 26 | VM1030120 | |
| 10 | 3 | 6000 | 3-1/2 | 1-15/16 | 3/4 | 1-3/8 | 11/16 | 26 | | VM1030912 |
| 10 | 3 | 6000 | 3-1/2 | 1-15/16 | 1 | 1-3/8 | 11/16 | 26 | | VM1030916 |

* R = Roller Bearing, P = Precision Ball Bearing, T= Tapered Roller Bearing

Available in STEEL or STAINLESS STEEL with precision ball bearings and end caps.

CAST IRON - CA

Capacity Up to 8000 lbs.



Cast Iron, sometimes referred to as semi-steel, offers the highest tensile strength in the industry (30,000 psi). A cost-effective solution for high capacity applications.

Features:

- **Wheel face:** Machined flat with rounded edges.
- **Finish:** Gray enamel.
- **Temperature Range:** Up to 800°F, consult Acorn™.
- **Hardness:** Brinell 145.

Wheel Options:

- **Note:** Select bearings featured are recommended for standard applications. For special applications or alternate bearings, consult Acorn™.
- For customization & special application options, please consult Acorn™.

| Dia. (inch) | Width (inch) | Capacity (lbs) | Hub Length (inch) | Bore (inch) | Bearing (inch) | Wt. (lbs) | Part Number* |
|-------------|--------------|----------------|-------------------|-------------|----------------|-----------|--------------|
| 4 | 3 | 2000 | 3-1/4 | 1-15/16 | 1 | 8-1/4 | CA0430116 |
| 4 | 3 | 2000 | 3-1/4 | 1-15/16 | 1-1/4 | 8-1/4 | CA0430120 |
| 4 | 4 | 4000 | 4-1/4 | 2-7/16 | 1-1/4 | 10-3/4 | CA0440120 |
| 4 | 4 | 4000 | 4-1/4 | 2-7/16 | 1-1/2 | 10-3/4 | CA0440124 |
| 6 | 3 | 2800 | 3-1/4 | 1-15/16 | 1 | 11-3/4 | CA0630116 |
| 6 | 3 | 2800 | 3-1/4 | 1-15/16 | 1 1/4 | 11-3/4 | CA0630120 |
| 6 | 3 | 2800 | 3-1/2 | 1-15/16 | 3/4 | 11-1/2 | CA0630912 |
| 8 | 2 | 1800 | 2-3/16 | 1-3/16 | 1/2 | 8-1/2 | CA0820108 |
| 8 | 2 | 1800 | 2-3/16 | 1-3/16 | 5/8 | 8-1/2 | CA0820110 |
| 8 | 2 | 1800 | 2-3/16 | 1-3/16 | 3/4 | 8-1/2 | CA0820112 |
| 8 | 3 | 2800 | 3-1/4 | 1-15/16 | 1 | 11-3/4 | CA0830116 |
| 8 | 3 | 2800 | 3-1/4 | 1-15/16 | 1-1/4 | 11-3/4 | CA0830120 |
| 8 | 3 | 2800 | 3-1/2 | 1-15/16 | 3/4 | 11-1/2 | CA0830912 |
| 8 | 4 | 4000 | 4-1/4 | 2-7/16 | 1-1/4 | 27-1/4 | CA0840120 |
| 8 | 4 | 4000 | 4-1/4 | 2-7/16 | 1-1/2 | 27-1/4 | CA0840124 |
| 8 | 4 | 6000 | 4-1/2 | 2-7/16 | 1 | 26-1/2 | CA0840916 |
| 8 | 4 | 6000 | 4-1/2 | 2-7/16 | 1-1/4 | 26-1/2 | CA0840920 |
| 10 | 3 | 2800 | 3-1/4 | 1-15/16 | 1 | 16-3/4 | CA1030116 |
| 10 | 3 | 2800 | 3-1/4 | 1-15/16 | 1-1/4 | 16-3/4 | CA1030120 |
| 10 | 3 | 2800 | 3-1/2 | 1-15/16 | 3/4 | 16-1/2 | CA1030912 |
| 10 | 4 | 4000 | 4-1/4 | 2-7/16 | 1-1/4 | 33 | CA1040120 |
| 10 | 4 | 4000 | 4-1/4 | 2-7/16 | 1-1/2 | 33 | CA1040124 |
| 10 | 4 | 6000 | 4-1/2 | 2-7/16 | 1 | 32-1/2 | CA1040916 |
| 10 | 4 | 6000 | 4-1/2 | 2-7/16 | 1-1/4 | 32-1/2 | CA1040920 |
| 12 | 3 | 2800 | 3-1/4 | 1-15/16 | 1 | 22 | CA1230116 |
| 12 | 3 | 2800 | 3-1/4 | 1-15/16 | 1-1/4 | 22 | CA1230120 |
| 12 | 3 | 2800 | 3-1/2 | 1-15/16 | 3/4 | 21-3/4 | CA1230912 |
| 14 | 4 | 4000 | 4-1/4 | 2-7/16 | 1-1/4 | 49-1/2 | CA1440120 |
| 14 | 4 | 4000 | 4-1/4 | 2-7/16 | 1-1/2 | 49-1/2 | CA1440124 |
| 16 | 3 | 4000 | 4-1/4 | 2-7/16 | 1-1/4 | 52-1/4 | CA1630120 |
| 16 | 3 | 4000 | 4-1/4 | 2-7/16 | 1-1/2 | 52-1/4 | CA1630124 |
| 16 | 4 | 5000 | 5-1/4 | 2-7/16 | 1-1/4 | 65-1/4 | CA1640120 |
| 16 | 4 | 5000 | 5-1/4 | 2-7/16 | 1-1/2 | 65-1/4 | CA1640124 |
| 18 | 3 | 4000 | 4-1/4 | 2-7/16 | 1-1/4 | 58 | CA1830120 |
| 18 | 3 | 4000 | 4-1/4 | 2-7/16 | 2 | 58 | CA1830124 |

CAST IRON LARGE BORE CW



| Dia. (inch) | Width (inch) | Capacity (lbs) | Hub Length (inch) | Bore (inch) | Bearing (inch) | Wt. (lbs) | Part Number* |
|---|--------------|----------------|-------------------|-------------|----------------|-----------|------------------|
| LARGE BORE PREMIUM CAST IRON (CA/LB) WITH HIGH TENSILE STRENGTH 30,000 PSI | | | | | | | |
| 8 | 3 | 6000 | 3-1/4 | 2-7/16 | 1-1/4 | 21-3/4 | CW0830120 |
| 8 | 3 | 6000 | 3-1/4 | 2-7/16 | 1-1/2 | 21-3/4 | CW0830124 |
| 8 | 3 | 8000 | 3-1/2 | 2-7/16 | 1 | 21-1/2 | CW0830916 |
| 8 | 3 | 8000 | 3-1/2 | 2-7/16 | 1-1/4 | 21-1/2 | CW0830920 |

*R = Roller Bearing, P = Precision Ball Bearing, T = Tapered Roller Bearing

CAST IRON HIGH TENSILE CH



| Dia. (inch) | Width (inch) | Capacity (lbs) | Hub Length (inch) | Bore (inch) | Bearing (inch) | Wt. (lbs) | Part Number Roller Bearing (01) | Part Number Bronze Bearing (22)* | Part Number Annular Ball Bearing (31) |
|---|--------------|----------------|-------------------|-------------|----------------|-----------|---------------------------------|----------------------------------|---------------------------------------|
| HEAVY DUTY PREMIUM CAST IRON (CA/HT) WITH HIGH TENSILE STRENGTH 30,000 PSI | | | | | | | | | |
| 5 | 2 | 1500 | 2-3/16 | 1-3/16 | 1/2 | 4-1/4 | CH0520108 | | CH0523108 |
| 5 | 2 | 1500 | 2-3/16 | 1-3/16 | 5/8 | 4-1/4 | CH0520110 | | |
| 5 | 2 | 1500 | 2-3/16 | 1-3/16 | 3/4 | 4-1/4 | CH0520112 | CH0522212 | |
| 6 | 2 | 1700 | 2-3/16 | 1-3/16 | 1/2 | 6-1/4 | CH0620108 | | CH0623108 |
| 6 | 2 | 1700 | 2-3/16 | 1-3/16 | 5/8 | 6-1/4 | CH0620110 | | |
| 6 | 2 | 1700 | 2-3/16 | 1-3/16 | 3/4 | 6-1/4 | CH0620112 | CH0622212 | |
| 8 | 2 | 1800 | 2-3/16 | 1-3/16 | 1/2 | 8-1/2 | CH0820108 | | CH0823108 |
| 8 | 2 | 1800 | 2-3/16 | 1-3/16 | 5/8 | 8-1/2 | CH0820110 | | |
| 8 | 2 | 1800 | 2-3/16 | 1-3/16 | 3/4 | 8-1/2 | CH0820112 | CH0822212 | |

*R = Roller Bearing, P = Precision Ball Bearing, T = Tapered Roller Bearing

CAST IRON/ FLANGED - FL

Capacity Up to 8000 lbs.



Various bore sizes available for use as plain bore wheels or to be used with keyway and set screw, or with a variety of bearings. Cast iron offers 30,000 psi tensile strength.

Features

- **Finish:** Gray enamel.
- **Temperature Range:** Up to 800°F, consult Acorn™.
- **Hardness:** Brinell 145.

Wheel Options

- **Note:** Select bearings featured are recommended for standard applications. For special applications or alternate bearings, consult factory.
- For customization & special application options, please consult Acorn™.

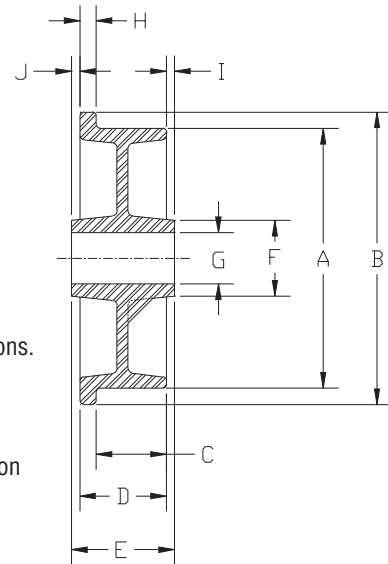

SINGLE FLANGED WHEELS (Dimensions in Inches)

| Face Dia. "A" | Flange OD "B" | Face Width "C" | OA Width "D" | Hub Length "E" | Hub OD "F" | Bore "G" | Flange Width "H" | Hub Offset "I" | Hub Offset "J" | Capacity (lbs) | Bearing ID (inch) | Approx. Wt (lbs) | Part # R=Roller Brg T=Taper Brg |
|---------------|---------------|----------------|--------------|----------------|------------|----------|------------------|----------------|----------------|----------------|-------------------|------------------|---------------------------------------|
| 3 | 4 | 1 | 1-3/8 | 2-3/16 | 1-5/8 | 1-3/16 | 3/8 | 9/16 | 1/4 | 700 | 3/4 | 3 | FL0320112 |
| 3-1/4 | 4 | 1 | 1-3/8 | 2-3/16 | 1-3/4 | 1-3/16 | 3/8 | 19/32 | 7/32 | 700 | 3/4 | 3 | FL0310112 |
| 4-1/2 | 5-1/2 | 1-9/16 | 2-3/8 | 2-1/2 | 2-1/2 | 1-15/16 | 13/16 | 1/16 | 1/16 | 1500 | 1 | 9-1/2 | FL0410116 |
| 4-1/2 | 5-1/2 | 1-9/16 | 2-3/8 | 2-1/2 | 2-1/2 | 1-15/16 | 13/16 | 1/16 | 1/16 | 1500 | 3/4 | 9-1/2 | FL0410912 |
| 5 | 6 | 1-1/8 | 1-1/2 | 2-3/16 | 1-3/4 | 1-3/16 | 3/8 | 11/32 | 11/32 | 500 | 3/4 | 5-1/4 | FL0510112 |
| 5-3/8 | 6-1/8 | 1-5/16 | 1-11/16 | 2-3/16 | 1-3/4 | 1-3/16 | 3/8 | 13/32 | 3/32 | 900 | 3/4 | 5 | FL0520112 |
| 5 | 6 | 1-1/8 | 1-15/16 | 3-1/4 | 2-1/2 | 1-15/16 | 13/16 | 15/16 | 3/8 | 1000 | 1 | 6-1/2 | FL0520116 |
| 5 | 6 | 1-1/8 | 1-15/16 | 3-1/4 | 2-1/2 | 1-15/16 | 13/16 | 15/16 | 3/8 | 1000 | 3/4 | 6-1/2 | FL0520912 |
| 6 | 6-3/4 | 1-5/8 | 2 | 2-3/16 | 1-3/4 | 1-3/16 | 3/8 | 3/32 | 3/32 | 900 | 3/4 | 8-1/2 | FL0620112 |
| 7-1/16 | 8-3/4 | 1-3/4 | 2-3/16 | 2-3/4 | 3-1/4 | 1-15/16 | 7/16 | 9/32 | 9/32 | 1200 | 1 | 12-3/4 | FL0720116 |
| 7-1/16 | 8-3/4 | 1-3/4 | 2-3/16 | 2-3/4 | 3-1/4 | 1-15/16 | 7/16 | 9/32 | 9/32 | 1200 | 3/4 | 12-3/4 | FL0720912 |
| 8 | 9-1/2 | 2 | 2-1/2 | 3-1/4 | 3 | 1-15/16 | 1/2 | 3/8 | 3/8 | 1600 | 1 | 16-1/4 | FL0840116 |
| 8 | 9-1/2 | 2 | 2-1/2 | 3-1/4 | 3 | 1-15/16 | 1/2 | 3/8 | 3/8 | 1600 | 3/4 | 16-1/4 | FL0840912 |
| 10 | 12 | 2-3/8 | 3 | 3-1/4 | 3 | 1-15/16 | 5/8 | 1/8 | 1/8 | 2000 | 1 | 29-1/4 | FL1050116 |
| 10 | 12 | 2-3/8 | 3 | 3-1/4 | 3 | 1-15/16 | 5/8 | 1/8 | 1/8 | 2000 | 3/4 | 29-1/4 | FL1050912 |
| 14 | 16 | 3 | 3-5/8 | 4-1/4 | 4-1/4 | 2-7/16 | 5/8 | 5/16 | 5/16 | 3000 | 1-1/4 | 56 | FL1460120 |
| 14 | 16 | 3 | 3-5/8 | 4-1/4 | 4-1/4 | 2-7/16 | 5/8 | 5/16 | 5/16 | 3000 | 1 | 56 | FL1460916 |

DOUBLE FLANGED WHEELS (Dimensions in Inches)

| Face Dia. "A" | Flange OD "B" | Face Width "C" | OA Width "D" | Hub Length "E" | Hub OD "F" | Bore "G" | Flange Width "H" | Hub Offset "I" | Hub Offset "J" | Capacity (lbs) | Bearing ID (inch) | Approx. Wt (lbs) | Part # R=Roller Brg T=Taper Brg |
|---------------|---------------|----------------|--------------|----------------|------------|----------|------------------|----------------|----------------|----------------|-------------------|------------------|---------------------------------------|
| 5 | 6 | 3/4 | 1-1/2 | 2-3/16 | 1-3/4 | 1-3/16 | 3/8 | 11/32 | 11/32 | 500 | 3/4 | 6 | FD0510112 |
| 10 | 12 | 1-3/4 | 3 | 3-1/4 | 3 | 1-15/16 | 5/8 | 1/8 | 1/8 | 2000 | 1 | 35 | FD1050116 |
| 10 | 12 | 1-3/4 | 3 | 3-1/4 | 3 | 1-15/16 | 5/8 | 1/8 | 1/8 | 2000 | 3/4 | 35 | FD1050912 |

CAST IRON/V-GROOVE

CAST IRON/ V-GROOVE - CA/VG

Capacity Up to 8000 lbs.

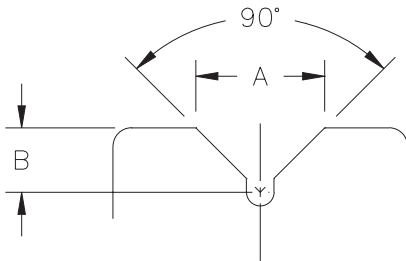

Wheel face and V-groove are machined from heavy duty cast iron. A relief groove at the base of the “V” tends to equalize the load to each face of the angle track when in operation. Wheel face and bore are machined for concentricity to proper tracking. These wheels can be used not only on track but flat surfaces as well. **CA/VL wheels feature a larger bore for greater capacity.**

Please note: Track alignment is critical when utilizing V-groove wheels.

Wheel Options

- **Note:** Select bearings featured are recommended for standard applications. For special applications or alternate bearings, consult Acorn™.
- For customization & special application options, consult Acorn™.

| Wheel Dia. (inch) | Tread Width (inch) | Capacity (lbs) | Hub Length (inch) | Bore ID (inch) | Bearing ID (inch) | Groove Width “A” | Groove Depth “B” | Approx. Weight (lbs) | Part # R= Roller Bearing |
|-------------------|--------------------|----------------|-------------------|----------------|-------------------|------------------|------------------|----------------------|-----------------------------|
| 4 | 2 | 800 | 2-3/16 | 1-3/16 | 5/8 | 7/8 | 7/16 | 4 | VG0420110 |
| 4 | 2 | 800 | 2-3/16 | 1-3/16 | 3/4 | 7/8 | 7/16 | 4 | VG0420112 |
| 5 | 2 | 800 | 2-3/16 | 1-3/16 | 5/8 | 7/8 | 7/16 | 5 | VG0520110 |
| 5 | 2 | 800 | 2-3/16 | 1-3/16 | 3/4 | 7/8 | 7/16 | 5 | VG0520112 |
| 6 | 2 | 1000 | 2-3/16 | 1-3/16 | 5/8 | 7/8 | 7/16 | 8 | VG0620110 |
| 6 | 2 | 1000 | 2-3/16 | 1-3/16 | 3/4 | 7/8 | 7/16 | 8 | VG0620112 |
| 8 | 3 | 2500 | 3-1/4 | 1-15/16 | 1 | 7/8 | 7/16 | 16-3/4 | VG0830116 |
| 8 | 3 | 2500 | 3-1/4 | 1-15/16 | 1-1/4 | 7/8 | 7/16 | 16-3/4 | VG0830120 |
| 8 | 3 | 2500 | 3-1/2 | 1-15/16 | 3/4 | 7/8 | 7/16 | 16-1/2 | VG0830920 |
| 8 | 3 | 2500 | 3-1/2 | 1.98 | 1 | 7/8 | 7/16 | 16-1/2 | VG0830916 |
| 8 | 3 | 4000 | 3-1/4 | 2-7/16 | 1-1/4 | 1-3/8 | 11/16 | 17-3/4 | VL0830120 |
| 8 | 3 | 4000 | 3-1/4 | 2-7/16 | 1-1/2 | 1-3/8 | 11/16 | 17-3/4 | VL0830124 |
| 8 | 3 | 4000 | 3-1/2 | 2-7/16 | 1 | 1-3/8 | 11/16 | 17-1/4 | VL0830916 |
| 8 | 3 | 4000 | 3-1/2 | 2-7/16 | 1-1/4 | 1-3/8 | 11/16 | 17-1/4 | VL0830920 |
| 10 | 3 | 3000 | 3-1/4 | 1-15/16 | 1 | 1-3/8 | 11/16 | 27 | VG1030116 |
| 10 | 3 | 3000 | 3-1/4 | 1-15/16 | 1-1/4 | 1-3/8 | 11/16 | 27 | VG1030120 |
| 10 | 3 | 3500 | 3-1/2 | 1-15/16 | 3/4 | 1-3/8 | 11/16 | 26-3/4 | VG1030912 |
| 10 | 3 | 3500 | 3-1/2 | 2 | 1 | 1-3/8 | 11/16 | 26-3/4 | VG1030916 |
| 10 | 3 | 4000 | 3-1/4 | 2-7/16 | 1-1/4 | 1-3/8 | 11/16 | 28 | VL1030120 |
| 10 | 3 | 4000 | 3-1/4 | 2-7/16 | 1-1/2 | 1-3/8 | 11/16 | 28 | VL1030124 |
| 10 | 3 | 4000 | 3-1/2 | 2-7/16 | 1 | 1-3/8 | 11/16 | 27-1/4 | VL1030916 |
| 10 | 3 | 4000 | 3-1/2 | 2-11/32 | 1-1/4 | 1-3/8 | 11/16 | 27-1/4 | VL1030920 |

STEEL - STL

Capacity Up to 20,000 lbs.



6" x 2" Steel Wheel
with Precision Steel Ball Bearings
and two Steel Bearing End Caps

| Dia. (inch) | Width (inch) | Hub Length (inch) | Axle (inch) | Approx. Wt. (lb) | Capacity (lb) | Part Number P = Prec. Brg |
|-------------|--------------|-------------------|-------------|------------------|---------------|------------------------------|
| 4 | 1-1/2 | 1-5/8 | 1/2 | 7 | 600 | STLP041508 |
| 4 | 2 | 2-3/8 | 1/2 | 10 | 1000 | STLP042008 |
| 5 | 1-1/2 | 1-5/8 | 1/2 | 11 | 600 | STLP051508 |
| 5 | 2 | 2-3/8 | 1/2 | 14 | 1000 | STLP052008 |
| 6 | 1-1/2 | 1-5/8 | 1/2 | 15 | 600 | STLP061508 |
| 6 | 2 | 2-3/8 | 1/2 | 20 | 1000 | STLP062008 |
| 8 | 1-1/2 | 1-5/8 | 1/2 | 27 | 600 | STLP081508 |
| 8 | 2 | 2-3/8 | 1/2 | 36 | 1000 | STLP082008 |

P = Precision Ball bearing

Larger sizes available upon request.

Features

- Type 1018 steel .
- Magnetic.
- Wheels can be machined straight sided or machined to contour.
- Slightly crowned tread face with rounded corners.
- Furnished with plain bore/steel bushing, stainless steel roller bearing or steel precision bearing .
- Steel wheels can be made to your specifications or drawings.

Steel Wheels provide the highest degree of sanitation. Type 1018 is magnetic. All wheels are available with Sealed Precision Ball Bearings, Bushings or Roller Bearings. Custom sizes made to prints to fit any application.

ACORN™ MAKES END CAPS AND BUSHINGS TO FIT BEARING ID TO AXLE.



Custom Steel Wheels made by Acorn™ can be made in any size to fit any caster rig or wheel application and replace any type wheel.

- V-Groove
- Flanged
- Crown Tread
- Rollers

DROP FORGED STEEL - FS

Capacity Up to 11000 lbs.



Features

- ASTM 1045 high carbon steel is hot drop forged to improve grain structure of the wheel, enhancing ductibility and tensile strength. This is the ultimate extreme duty wheel.
- Offers the maximum weight capacity, impact strength, durability and rollability of all our wheels.
- Tread face is precisely machined for a smooth, central ride, tread edge is machine round.
- Precision & tapered bearings maximize mobility and performance in towing and severe use environments.
- Hardness: Rockwell 80 B.
- Tensile strength of 60,000 PSI.
- Temperature up to +1300°F.

| Diameter (inch) | Width (inch) | Hub Length | Capacity (lbs) | Roller Bearings | Tapered Bearings | Part Number |
|-----------------|--------------|------------|----------------|-----------------|------------------|-------------|
| 6 | 2 | 2-13/16 | 2500 | | 73 | FS62IT* |
| 6 | 3 | 3-1/4 | 8000 | 27 | | FS63IT* |
| 6 | 3 | 3-1/4 | 11000 | | 70, 71, 79 | FS63IT* |
| 8 | 2 | 2-13/16 | 3000 | | 73 | FS82IT* |
| 8 | 3 | 3-1/4 | 8000 | 27 | | FS83IT* |
| 8 | 3 | 3-1/4 | 11000 | | 70, 71, 79 | FS83IT* |
| 8 | 4 | 4-1/4 | 11000 | 33 | | FS84IT* |
| 10 | 3 | 3-1/4 | 8000 | 27 | | FS1030IT* |
| 10 | 3 | 3-1/4 | 11000 | | 70, 71, 79 | FS1030IT* |
| 12 | 3 | 3-1/4 | 8000 | 27 | | FS1230IT* |
| 12 | 3 | 3-1/4 | 11000 | | 70, 71, 79 | FS1230IT* |
| 12 | 4 | 4-1/4 | 11000 | 33 | | FS1240IT* |

Replace* with desired bearing code.

27, 33 Rolling Bearings

70, 71, 72, 79 Tapered Rolling Bearings w/top hat bushings

DUCTILE V-GROOVE - DV

Capacity Up to 7000 lbs.



Features

- Made specifically for use on inverted angle iron track; they can also be used on flat surfaces.
- Each wheel has a precisely machined 90° V-groove with relief groove which enables load equalization.
- Ductile steel is a combination of special alloys that give it higher weight capacities than cast iron, and is more economical than drop forged steel; also referred to malleable iron; material may flex rather than cracking or breaking when submitted to an extreme shock load.
- Extra thick walled, heavy-duty core, hub & tread face.
- Precision & tapered bearings maximize mobility and performance in towing and severe use environments.
- Tensile strength of 45,000 PSI.
- Temperature -45°F up to +800°F.

| Diameter (inch) | Width (inch) | Hub Length | Capacity (lbs) | Precision Ball Bearing* | Part Number |
|-----------------|--------------|------------|----------------|-------------------------|-------------|
| 6 | 2 | 2-3/16 | 1500 | 63 | DV60JT63 |
| 6 | 3 | 3-1/4 | 5000 | 65 | DV60LT65 |
| 6 | 3 | 3-1/4 | 5000 | 65 | DV60LW65 |
| 8 | 3 | 3-1/4 | 5000 | 65 | DV80LT65 |
| 8 | 3 | 3-1/4 | 5000 | 65 | DV80LW65 |
| 10 | 3 | 3-1/4 | 7000 | 65 | DV10LT65 |
| 10 | 3 | 3-1/4 | 7000 | 65 | DV10LW65 |

SOLID STEEL V-GROOVE - SV

Capacity Up to 5000 lbs.



Features

- Solid ASTM 1045 steel, straight sided construction offers the maximum weight capacity and durability of any V-groove type wheel on the market.
- Sealed precision ball bearings offer the best possible mobility and do not require any maintenance.
- Wheels are zinc plated to resist rust.
- Offers long service life; even in ongoing usage applications.
- Popular applications include use in casters and on sliding gates.
- Can be purchased as kits for gate use; includes bushings & axles.

| Diameter (inch) | Width (inch) | Hub Length | Capacity (lbs) | Precision Bearing w/Bushing 1/2 ID | Precision Bearing w/Bushing 5/8 ID* | Part Number |
|-----------------|--------------|------------|----------------|------------------------------------|-------------------------------------|-------------|
| 4 | 2 | 1-13/16 | 3000 | 14 | 19 | SV40IT14* |
| 6 | 2 | 1-13/16 | 5000 | 14 | 19 | SV60IT14* |

STAINLESS STEEL

STAINLESS STEEL - SS

Capacity Up to 20,000 lbs.



6" x 2" Stainless Steel Wheel
with Precision Stainless Steel Ball Bearings
and two Stainless Steel Bearing End Caps

| Dia. (in) | Width (in) | Hub Length (in) | Axle (in) | Approx. Wt. (lb) | Capacity (lb) | Part Number P = Prec. Brg |
|-----------|------------|-----------------|-----------|------------------|---------------|------------------------------|
| 4 | 1-1/2 | 1-5/8 | 1/2 | 7 | 600 | SSP041508 |
| 4 | 2 | 2-3/8 | 1/2 | 10 | 1000 | SSP042008 |
| 5 | 1-1/2 | 1-5/8 | 1/2 | 11 | 600 | SSP051508 |
| 5 | 2 | 2-3/8 | 1/2 | 14 | 1000 | SSP052008 |
| 6 | 1-1/2 | 1-5/8 | 1/2 | 15 | 600 | SSP061508 |
| 6 | 2 | 2-3/8 | 1/2 | 20 | 1000 | SSP062008 |
| 8 | 1-1/2 | 1-5/8 | 1/2 | 27 | 600 | SSP081508 |
| 8 | 2 | 2-3/8 | 1/2 | 36 | 1000 | SSP082008 |

P = Precision Ball bearing

Larger sizes available upon request.

Features

- Type 304 stainless steel.
- Non-magnetic.
- Non-sparking.
- Excellent corrosion resistance.
- Wheels can be machined straight sided or machined to contour.
- Excellent corrosion resistance.
- Slightly crowned tread face with rounded corners.
- Furnished with plain bore / stainless steel bushing, stainless steel roller bearing or stainless steel precision bearing.
- Stainless steel wheels can be made to your specifications or drawings.

Custom Stainless Steel Wheels made by Acorn™ can be made in any size to fit any caster rig or wheel application and replace any type wheel.

- V-Groove
- Flanged
- Crown Tread
- Rollers

Stainless Steel Wheels provide the highest degree of sanitation. Type 304 is a non-magnetic, non-sparking material with excellent corrosion resistance. All wheels are available with SS Sealed Precision Ball Bearings, SS Bushings or SS Roller Bearings. Custom sizes made to prints to fit any application.

ACORN™ MAKES END CAPS AND BUSHINGS TO FIT BEARING ID TO AXLE.

