



**Trio Pines**  
CASTERS

**2012 CATALOG**

# CASTER INFO

## Numbering System



*Series Number*

*Wheel Diameter*

*Fastening Type*

*Wheel Type*

*Options*

- 20 = 2"
- 25 = 2-1/2"
- 30 = 3"
- 35 = 3-1/2"
- 40 = 4"
- 50 = 5"
- 60 = 6"
- 80 = 8"
- 10 = 10"
- 12 = 12"

- 0 - = Top Plate
- 1 - = Grip Ring Stem
- 2 \* = Threaded Stem
- 3 \* = Round Stem
- 4 \* = Octagon Stem
- 5 \* = Square Stem
- 6 - = Grip Neck Stem (furniture casters)

- SR = Soft Rubber
- SRB = Soft Rubber with ball bearing
- HR = Hard Rubber
- HRB = Hard Rubber with ball bearing
- MIR = Rubber Tread Plastic Center
- RAL = Rubber Tread Aluminum Center
- RCI = Rubber Tread Cast Iron Center
- PLY = Polyurethane Tread Plastic Center
- PCI = Polyurethane Tread Cast Iron Center
- STL = Steel
- PHN = Phenolic
- LDP = Light Duty Plastic
- HDP = Heavy Duty Plastic
- HPB = Heavy Duty Plastic with ball bearing
- HPR = Heavy Duty Plastic with roller bearing
- RSD = Rubber Tread Steel Disc Center
- PRO = Pro-Tech Polyurethane
- VGR = V-Groove Steel
- RNY = Rubber Tread Nylon
- PRX = Pro-Tech Patriot
- PLE = High Elastic Polyurethane

# FASTENING TYPE

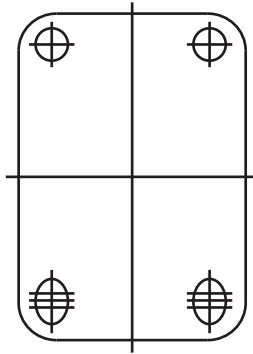

0\* = Top Plate

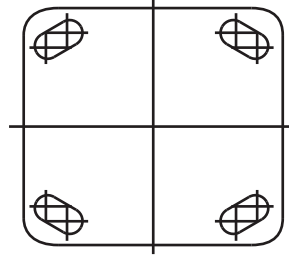

0\* = Slot Hole Spacing



1\* = Grip Ring Stem

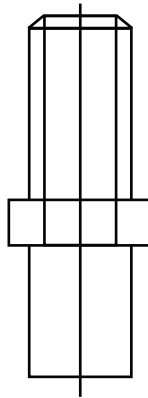

2\* = Threaded Stem

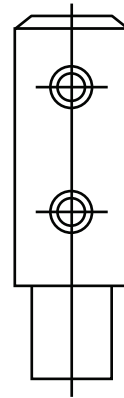

3\* = Round Stem

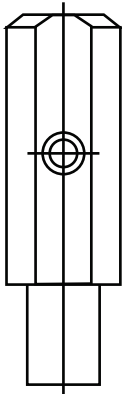

4\* = Octagon Stem

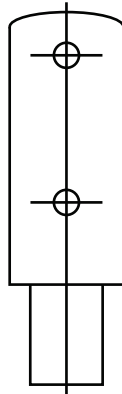

5\* = Square Stem

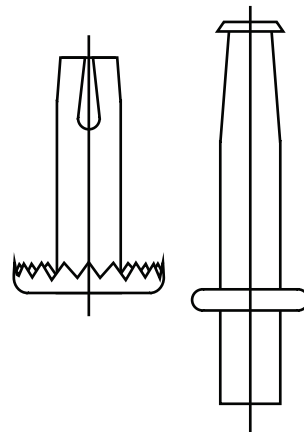

6\* = Grip Neck Stem  
(furniture casters)

# CONTENTS

SERIES	DESCRIPTION	LOAD CAPACITY	PAGES
<b>LIGHT DUTY CASTER</b>			
TP3000 Series	Light Duty Industrial Casters	Capacity up to 110 lbs.	8
TP3200 Series	Light Duty Industrial Casters	Capacity up to 150 lbs.	9
TP3600 Series	Light Duty Industrial Casters	Capacity up to 220 lbs.	10
<b>GENERAL DUTY CASTERS</b>			
TP4000 Series	General Duty Casters	Capacity up to 300 lbs.	12
<b>LIGHT-MEDIUM DUTY CASTERS</b>			
TP5000 Series	Light-Medium Duty Casters	Capacity up to 350 lbs.	14
TP5200 Series	Light-Medium Duty Casters	Capacity up to 350 lbs.	18
TP5800 Series	Medium Duty Casters	Capacity up to 450 lbs.	21
<b>MEDIUM-HEAVY DUTY CASTERS</b>			
TP6200 Series	Medium Duty Casters	Capacity up to 550 lbs.	22
TP6400 Series	Medium Duty Casters	Capacity up to 800 lbs.	23
TP6600 Series	Medium-Heavy Duty Casters	Capacity up to 1250 lbs.	24
TP6800 Series	Medium-Heavy Duty Casters	Capacity up to 1400 lbs.	27
<b>HEAVY DUTY CASTERS</b>			
TP6900 Series	Heavy Duty Casters	Capacity up to 1800 lbs.	29
TP7000 Series	Heavy Duty Casters	Capacity up to 1400 lbs.	30
TP7100 Series	Heavy Duty Casters	Capacity up to 2200 lbs.	31
TP7200 Series	Heavy Duty Casters	Capacity up to 2500 lbs.	32
TP7500 Series	Heavy Duty Casters	Capacity up to 3000 lbs.	33
TP7600 Series	Super Heavy Duty Casters	Capacity up to 4400 lbs.	34
<b>KINGPINLESS CASTERS</b>			
TP6600 KPL Series	Med / Heavy Kingpinless Casters	Capacity up to 1250 lbs.	35
TP6800 KPL Series	Med / Heavy Kingpinless Casters	Capacity up to 1400 lbs.	37
TP7200 KPL Series	Heavy Duty Kingpinless Casters	Capacity up to 2500 lbs.	39
TP7500 KPL Series	Heavy Duty Kingpinless Casters	Capacity up to 3000 lbs.	40
<b>AUTO INDUSTRIES CASTERS</b>			
TP6661MF	Auto Ind. / Maintenance Free Casters	Capacity up to 300 lbs.	41
TP7002MF	Auto Ind. / Maintenance Free Casters	Capacity up to 1500 lbs.	42
TP9600SA	Shock Absorbing Casters	Capacity up to 1200 lbs.	43
<b>STAINLESS STEEL CASTERS</b>			
TP5100 Series	Stainless Steel Casters	Capacity up to 325 lbs.	44
TP6700 Series	Med / Heavy Duty Stainless Steel Casters	Capacity up to 1250 lbs.	45
<b>SPECIAL CASTERS</b>			
TP1000 Series	Metal Ball Furniture Casters	Capacity up to 90 lbs.	47
TP1600 Series	Hooded Ball Furniture Casters	Capacity up to 90 lbs.	48
TP1800 Series	Locking Pin Casters	Capacity up to 100 lbs.	48
TP6600 Series	Pneumatic Casters	Capacity up to 500 lbs.	49
TP8020 Series	Low-Profile Machine Casters	Capacity up to 300 lbs.	50
TP8030 Series	Business Machine Casters	Capacity up to 1000 lbs.	51
TP8100 Series	Shopping Cart Casters	Capacity up to 250 lbs.	52
TP8200 Series	Aircraft Equipment Casters	Capacity up to 250 lbs.	53
TP8300 Series	Ladder Casters	Capacity up to 100 lbs.	54
TP8900 Series	Scaffold Casters	Capacity up to 800 lbs.	55
TP9300 Series	Workstation Casters	Capacity up to 1000 lbs.	56
TP9500 Series	Leveling Casters	Capacity up to 700 lbs.	57
<b>MEDICAL EQUIPMENT CASTERS</b>			
TP3700 Series	Light Duty Medical Casters	Capacity up to 140 lbs.	58
TP3840 Series	Medical Equipment Casters	Capacity up to 300 lbs.	59

SERIES	DESCRIPTION	LOAD CAPACITY	PAGES
TP8400 Series	Medical Equipment Casters	Capacity up to 280 lbs.	60
TP833~8454Series	Medical Equipment Casters	Capacity up to 220 lbs.	61
TP8600 Series	European Total Lock	Capacity up to 300 lbs.	62
TP8700 Series	Deluxe Total Lock	Capacity up to 240 lbs.	63
SR/ HR	Rubber Wheels	Capacity up to 220 lbs.	64
MIR	Mirage Rubber Wheels (TPR)	Capacity up to 600 lbs.	65
MRC	Crown Mirage Rubber Wheels (TPR)	Capacity up to 600 lbs.	66
RAL	Rubber / Aluminum Wheels	Capacity up to 500 lbs.	66
RND	Rubber Balloon Cushion Wheels	Capacity up to 450 lbs.	67
PLE	Hi-Elastic Polyurethane Wheels	Capacity up to 175 lbs.	67
PLY	Polyurethane Wheels	Capacity up to 270 lbs.	68
PRO	Pro-Tech Polyurethane Wheels	Capacity up to 1000 lbs.	69
PLX	Solid Polyurethane Wheels	Capacity up to 1000 lbs.	70
PRX	Pro-Tech Extra Polyurethane Wheels	Capacity up to 1200 lbs.	71
LDP	Light Duty Plastic Wheels	Capacity up to 250 lbs.	71
HDP	Heavy Duty Plastic Wheels	Capacity up to 800 lbs.	72
NYL	Nylon Wheels	Capacity up to 800 lbs.	73
PHN	Phenolic Wheels	Capacity up to 3500 lbs.	74
PHN-HT	Phenolic Hi-Temperature Wheels	Capacity up to 2500 lbs.	75
FVR	Fever Hi-Temperature Wheels	Capacity up to 1400 lbs.	76
FVT	Fever-Tech Hi-Temperature Wheels	Capacity up to 700 lbs.	76
NGF	Nylon Glass-Filed Wheels	Capacity up to 1400 lbs.	77
RTR	Retort Wheels	Capacity up to 900 lbs.	77
RCI	Rubber Tread Cast Iron Center Wheels	Capacity up to 1500 lbs.	78
RNY	Rubber / Nylon Wheels	Capacity up to 600 lbs.	79
PNY	Polyurethane / Nylon Wheels	Capacity up to 1400 lbs.	80
PCI	Polyurethane Tread Cast Iron Wheels	Capacity up to 3200 lbs.	81
STL	Steel Wheels	Capacity up to 2500 lbs.	82
SDI	Ductile Iron Wheels	Capacity up to 6000 lbs.	83
VGR	V-Groove Steel Wheels	Capacity up to 1000 lbs.	84
PNU	Pneumatic Wheels	Capacity up to 500 lbs.	85
AIR	Air Free Wheels	Capacity up to 300 lbs.	86
ZERO	Semi-Pneumatic Wheels	Capacity up to 850 lbs.	87
AXLE & NUT			88
BRAKES			89
BEARING			90
SPANNER BUSHING			91
FLOOR TRUCK LOCKS			91
CORNER BUMPER			92
CASTER DOCK			92

# Light Duty Industrial Casters

## TP3000 Series / Capacity up to 110 Lbs.

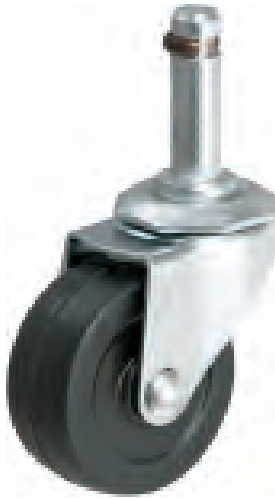

### Features

- Finish: Bright zinc plating
- Swivel: Double ball bearing raceways
- Construction: Formed steel for extra strength
- Axle: 15/64" diameter axle with lock nut

### Applications

- Office Equipment
- Store Display Stand Fixtures
- Utility Carts
- Institutional Equipment
- Furniture & Medical Equipment

### Caster Options

- TLB: Top Lock Brake



- FLB: Front Lock Brake (2" Only)



Wheel Diameter	Tread Width	Wheel Type	Swivel Number	Wheel Bearing	Load Capacity	Swivel Radius
2	13/16	Soft Rubber	TP3020-**-SR	Nylon	80	1-13/16
		Hard Rubber	TP3020-**-HR	Nylon	90	
		Mirage (TPR)	TP3020-**-MIR	Plain	80	
		Polyurethane	TP3020-**-PLY	Plain	80	
		Light Duty Plastic	TP3020-**-LDP	Plain	90	
2-1/2	13/16	Soft Rubber	TP3025-**-SR	Nylon	90	2-1/16
		Hard Rubber	TP3025-**-HR	Nylon	100	
		Light Duty Plastic	TP3025-**-LDP	Plain	100	
3	13/16	Soft Rubber	TP3030-**-SR	Nylon	100	2-3/8
		Hard Rubber	TP3030-**-HR	Nylon	110	
		Mirage (TPR)	TP3030-**-MIR	Plain	100	
		Polyurethane	TP3030-**-PLY	Plain	100	
		Light Duty Plastic	TP3030-**-LDP	Plain	110	

### Fastenings

TYPE	CODE	SIZE (Inch)		OVERALL HEIGHT		
				TP3020	TP3025	TP3030
Top Plate	01	Overall Size	1-1/4 x 2-1/16	2-5/8	3-1/8	3-5/8
		Bolt Hole Spacing	13/16 x 1-9/16			
		Attaching Bolt Size	3/16			
Grip Ring Stem	10	7/16 x 7/8		2-5/8	3-1/8	3-5/8
	11	7/16 x 1-3/16				
	12	7/16 x 1-7/16				
Threaded Stem	20	5/16-18 X 3/8		2-11/16	3-3/16	3-11/16
	21	5/16-18 x 1/2				
	22	5/16-18 x 3/4				
	23	5/16-18 x 1				
	24	5/16-18 x 1-1/4				
	25	3/8-16 x 1/2				
	26	3/8-16 x 5/8				
	27	3/8-16 x 1				
	28	3/8-16 x 1-1/4				
29	3/8-16 x 1-1/2					

### Options

CODE	DESCRIPTION
BX	Black Oxide Plating
CR	Chrome Plating
NK	Nickel Plating
RoHS	RoHS compliant
FLB	Front Lock Brake (TP3020 Only)
TLB	Top Lock Brake

Add Option Code to end of part number.

Replace -\*\*- in part number with appropriate fastening code.

### Wheel Options

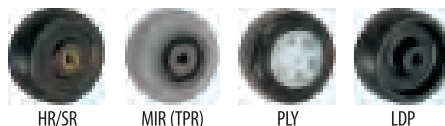

# Light Duty Industrial Casters

## TP3200 Series / Capacity up to 150 Lbs.



### Features

- Finish: Bright zinc plating
- Swivel: Double ball bearing raceways
- Construction: Formed steel for extra strength
- Axle: 1/4" diameter axle with lock nut

### Applications

- Office Equipment
- Store Display Stand Fixtures
- Utility Carts
- Institutional Equipment
- Furniture & Medical Equipment

### Caster Options

- TLB: Top Lock Brake



- -01-Top Plate



- -02-Top Plate



Wheel Diameter	Tread Width	Wheel Type	Swivel Number	Wheel Bearing	Load Capacity	Swivel Radius
2	15/16	Soft Rubber	TP3220-**-SR	Nylon	90	2
		Hard Rubber	TP3220-**-HR	Nylon	125	
		Mirage Rubber	TP3220-**-MIR	Plain	90	
		Polyurethane	TP3220-**-PLY	Plain	90	
		Steel	TP3220-**-STL	Plain	125	
		Light Duty Plastic	TP3220-**-LDP	Plain	125	
3	15/16	Soft Rubber	TP3230-**-SR	Nylon	100	2-1/2
		Hard Rubber	TP3230-**-HR	Nylon	150	
		Light Duty Plastic	TP3230-**-LDP	Plain	150	

Fastenings					
TYPE	CODE	SIZE (Inch)		OVERALL HEIGHT	
				TP3220	TP3230
Top Plate	01	Overall Size	2-3/4 x 3-3/4	2-13/16	3-7/8
		Bolt Hole Spacing	1-3/4 x 2-15/16		
		Attaching Bolt Size	5/16		
	02	Overall Size	2-3/8 x 2-3/8		
Bolt Hole Spacing		1-7/8 x 1-7/8 to 1-5/8 x 1-5/8			
Attaching Bolt Size		5/16			
Grip Ring Stem	12	7/16 x 1-7/16		2-13/16	3-7/8
Threaded Stem	20	5/16-18 x 3/8		2-7/8	3-7/8
	21	5/16-18 x 1/2			
	22	5/16-18 x 3/4			
	23	5/16-18 x 1			
	24	5/16-18 x 1-1/4			
	25	3/8-16 x 1/2			
	26	3/8-16 x 3/4			
	27	3/8-16 x 1			
28	3/8-16 x 1-1/4				
	29	3/8-16 x 1-1/2			

Options	
CODE	DESCRIPTION
BX	Black Oxide Plating
CR	Chrome Plating
NK	Nickel Plating
RoHS	RoHS compliant
TLB	Top Lock Brake

Replace-\*\*-in part number with appropriate fastening code.

### Wheel Options

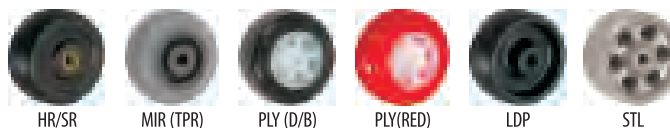

# Light Duty Industrial Casters

## TP3600 Series / Capacity up to 220 Lbs. each



### Features

- Finish: Bright zinc plating
- Swivel: Double ball bearing raceways
- Rigid: Single piece pressed to form for extra strength
- Construction: Heavy duty gauge steel formed for extra strength
- Axle: 5/16" diameter axle with lock nut
- Applicators: Rubber Expanding Adapters & Pipe Threaded Stems available
- OUP: Octagonal upper cup standard on threaded stem casters

### Applications

- Utility Stock Carts
- Institutional equipment
- Food service equipment
- Display Racks

### Caster Options

- TLB: Top Lock Brake



- REA: Rubber Expanding Adapter



- PS: Pipe Stem



Wheel Diameter	Tread Width	Wheel Type	Swivel Number	Rigid Number	Wheel Bearing	Load Capacity	Overall Height	Swivel Radius
2-1/2	1	Soft Rubber	TP3625-**-SR	TP3625R-01-SR	Nylon	77	3-1/4	2-1/8
		Hard Rubber	TP3625-**-HR	TP3625R-01-HR	Nylon	100		
		Polyurethane	TP3625-**-PLY	TP3625R-01-PLY	Plain	100		
3	1	Mirage (TPR)	TP3630-**-MIR	TP3630R-01-MIR	Plain	120	3-3/4	2-5/8
		Soft Rubber	TP3630-**-SR	TP3630R-01-SR	Nylon	100		
		Hard Rubber	TP3630-**-HR	TP3630R-01-HR	Nylon	125		
		Light Duty Plastic	TP3630-**-LDP	TP3630R-01-LDP	Plain	125		
		Polyurethane	TP3630-**-PLY	TP3630R-01-PLY	Plain	130		
4	1	Mirage (TPR)	TP3640-**-MIR	TP3640R-01-MIR	Plain	130	4-3/4	3-1/8
		Soft Rubber	TP3640-**-SR	TP3640R-01-SR	Nylon	125		
		Hard Rubber	TP3640-**-HR	TP3640R-01-HR	Nylon	150		
		Light Duty Plastic	TP3640-**-LDP	TP3640R-01-LDP	Plain	175		
		Heavy Duty Plastic	TP3640-**-HDP	TP3640R-01-HDP	Plain	200		
		Polyurethane	TP3640-**-PLY	TP3640R-01-PLY	Plain	150		
5	1	Mirage (TPR)	TP3650-**-MIR	TP3650R-01-MIR	Plain	140	5-3/4	3-3/4
		Soft Rubber	TP3650-**-SR	TP3650R-01-SR	Nylon	140		
		Hard Rubber	TP3650-**-HR	TP3650R-01-HR	Nylon	160		
		Light Duty Plastic	TP3650-**-LDP	TP3650R-01-LDP	Plain	200		
		Heavy Duty Plastic	TP3650-**-HDP	TP3650R-01-HDP	Plain	220		
		Polyurethane	TP3650-**-PLY	TP3650R-01-PLY	Plain	160		



# Light Duty Industrial Casters

**TP3600 Series**

Fastenings				
Type	CODE	SIZE (Inch)		
Top Plate	<b>01</b>	2.5" Swivel	Overall Size	2-3/8 x 2-3/4
			Bolt Hole Spacing	1-5/8 x 2-1/8
			Attaching Bolt Size	5/16
		2.5" Rigid	Overall Size	1-13/16 x 2-3/4
			Bolt Hole Spacing	1-1/8 x 1-3/4
			Attaching Bolt Size	5/16
	<b>3",4",5"</b>	Overall Size	2-3/4 x 3-3/4	
		Bolt Hole Spacing	1-3/4 x 2-7/8 slotted to 3"	
		Attaching Bolt Size	5/16	
Grip Ring Stem	<b>11</b>	7/16 x 1-1/2		
Threaded Stem	20	1/2 - 13 x 1"		
	<b>21</b>	1/2 - 13 x 1-1/2"		
	22	7/16 - 14 x 2-1/4"		
	23	1/2 - 13 x 2-3/4" fully threaded		
	24	1/2 - 13 x 1"		
	<b>26</b>	1/2 - 13 x 2-3/4" half threaded for X-Stem kits		
	Rubber Expanding Adapter	<b>CODE</b>	<b>ID of Tube</b>	<b>Size Range</b>
71		3/4"	0.720" ~ 0.851"	
72		7/8"	0.852" ~ 0.927"	
72A		1"	0.928" ~ 1.029"	
73		1-1/8"	1.030" ~ 1.140"	
74		1-3/16"	1.178" ~ 1.303"	
75		1-3/8"	1.360" ~ 1.425"	
76		1-1/2"	1.426" ~ 1.589"	
77		1-3/4"	1.685" ~ 1.800"	
Pipe Stem	<b>CODE</b>	<b>Threaded Size (NPT)</b>	<b>Pipe Socket # Only</b>	
	81	3/4"	PS-81	
	82	1"	PS-82	
	83	1-1/4"	PS-83	

Options	
CODE	DESCRIPTION
CR	Chrome Plating
LPS	Hex Nut Base (Threaded Stem Casters)
TG	Thread Guards (Ball Bearing Wheels)
<b>TLB</b>	Top Lock Brake
REA	Rubber Expanding Adapter
PS	Pipe Stem

Add Option Code to end of part number.

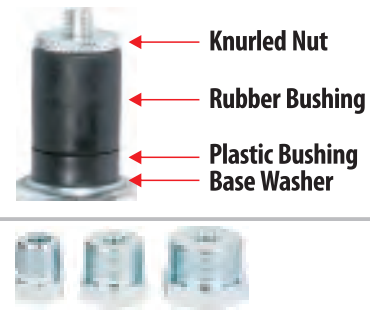

Replace -\*\* - in part number with appropriate fastening code.

## Wheel Options



## Caster Selection Guide



# General Duty Casters

## TP4000 Series / Capacity up to 300 Lbs.



### Features

- Finish: Bright zinc plating
- Swivel: Single ball bearing raceways
- Rigid: Pressed with heavy duty gauge steel for extra strength
- Construction: Heavy duty gauge steel formed for extra strength
- Axle: 2" wheels use 1/4" diameter axle with lock nut  
2-1/2" wheels use 5/16" diameter axle with lock nut  
3" wheels use 3/8" diameter axle with lock nut  
4" wheels use 7/16" diameter axle with lock nut

### Applications

- Dollies
- Institutional equipment
- Furniture
- Display & Merchandiser Racks

### Caster Options

- SLB: Side Lock Brake



- RIGID

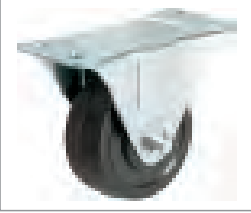

- SO: Short Offset



Wheel Diameter	Tread Width	Wheel Type	Swivel Number	Rigid Number	Wheel Bearing	Load Capacity	Overall Height	Swivel Radius
1-1/8	9/16	Light Duty Plastic	TP4011-01-LDP	--	Plain	30	1-9/16	7/8
1-1/4	9/16	Polyurethane	TP4012-01-PLY	TP4012R-01-PLY	Plain	30	1-3/4	1
1-1/2	3/4	Light Duty Plastic	TP4015-01-LDP	TP4015R-01-LDP	Plain	60	2-3/16	1-9/16
2	1	Mirage (TPR)	TP4020-01-MIR	TP4020R-01-MIR	Plain	90	2-7/16	1-3/4
		Soft Rubber	TP4020-01-SR	TP4020R-01-SR	Nylon	90		
		Hard Rubber	TP4020-01-HR	TP4020R-01-HR	Nylon	125		
		Light Duty Plastic	TP4020-01-LDP	TP4020R-01-LDP	Plain	125		
		Steel	TP4020-01-STL	TP4020R-01-STL	Plain	125		
		Aluminum	TP4020-01-AL	TP4020R-01-AL	Plain	125		
Polyurethane	TP4020-01-PLY	TP4020R-01-PLY	Plain	90				
2-1/2	1-1/8	Soft Rubber	TP4025-01-SR	TP4025R-01-SR	Nylon	100	3-1/4	2-3/8
		Hard Rubber	TP4025-01-HR	TP4025R-01-HR	Nylon	175		
		Light Duty Plastic	TP4025-01-LDP	TP4025R-01-LDP	Plain	175		
		Steel	TP4025-01-STL	TP4025R-01-STL	Plain	220		
		Polyurethane	TP4025-01-PLY	TP4025R-01-PLY	Plain	175		
3	1-1/4	Mirage (TPR)	TP4030-01-MIR-PB	TP4030R-01-MIR-PB	Plain	200	3-3/4	2-7/16
		Soft Rubber	TP4030-01-SR	TP4030R-01-SR	Nylon	150		
		Hard Rubber	TP4030-01-HR	TP4030R-01-HR	Nylon	220		
		Light Duty Plastic	TP4030-01-LDP	TP4030R-01-LDP	Plain	210		
		Heavy Duty Plastic	TP4030-01-HDP	TP4030R-01-HDP	Plain	250		
		Steel	TP4030-01-STL	TP4030R-01-STL	Plain	250		
		Polyurethane	TP4030-01-PLY	TP4030R-01-PLY	Plain	220		
		Polyurethane	TP4030-01-PLY-PB	TP4030R-01-PLY-PB	Ball	220		
4	1-1/4	Soft Rubber	TP4040-01-SR	TP4040R-01-SR	Nylon	200	5	2-1/4
		Hard Rubber	TP4040-01-HR	TP4040R-01-HR	Nylon	300		
		Heavy Duty Plastic	TP4040-01-HDP	TP4040R-01-HDP	Plain	300		
		Steel	TP4040-01-STL	TP4040R-01-STL	Plain	300		

# General Duty Casters

TP4000 Series

Top Plate Specifications				
WHEEL DIAMETER (inch)	OVERALL SIZE (inch)	BOLT HOLE SPACING (inch)	ATTACHING BOLT SIZE (inch)	
<b>SWIVEL</b>				
1-1/8	(TP4011-01)	1-3/16 x 1-25/32	25/32 x 1-3/8	3/16
1-1/4	(TP4012-01)	1-3/16 x 2-3/8	1-3/4	3/16
1-1/2	(TP4015-01)	1-1/2 x 2-5/32	1-1/16 x 1-47/64	3/16
2	(TP4020-01)	1-7/8 x 2-9/16	15/16 x 2-1/8	1/4
2-1/2	(TP4025-01)	2-3/4 x 3-7/8	1-3/4 x 3	5/16
3	(TP4030-01)	3-1/8 x 4-1/8	2-3/8 x 3-3/8 to 3-7/16	5/16
	(TP4030-03)	3-1/8 x 4-1/8	1-3/4 x 3 to 2-3/8 x 3-3/8	3/8
4	(TP4040-01)	4 x 5-1/8	3 x 4	3/8
<b>RIGID</b>				
1-1/4	(TP4012R-01)	1 x 2-3/8	1-3/4	3/16
1-1/4	(TP4012R-02)	1-3/16 x 1-3/4	13/16 x 1-3/4	11/64
1-1/4	(TP4015R-01)	1-1/2 x 2-5/32	1-1/16 x 1-47/64	3/16
2	(TP4020R-01)	1-1/2 x 2-21/32	15/16 x 2-1/8	1/4
2-1/2	(TP4025R-01)	2-1/4 x 4-7/16	1-1/16 x 3-1/2	5/16
3	(TP4030R-01)	2-1/2 x 4-15/16	1-3/16 x 4	5/16
4	(TP4040R-01)	3-1/8 x 6-1/4	1-3/4 x 5	3/8

Options	
CODE	DESCRIPTION
BX	Black Oxide Plating
SLB	Side Lock Brake
SO	Short Offset Optional 2-5/16" (TP4030 Swivel only)

Add Option Code to end of part number.

Replace -\*\* in part number with appropriate fastening code.

## Caster Selection Guide

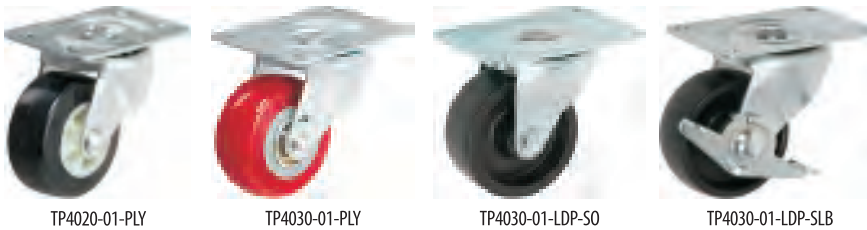

TP4020-01-PLY

TP4030-01-PLY

TP4030-01-LDP-SO

TP4030-01-LDP-SLB

## Wheel Options

### TP4020 SERIES



SR/HR-2B1

MIR-2B1

PLY-2B1 (RED)

PLY-2B1 (D/B)

STL-2B1

### TP4025 SERIES

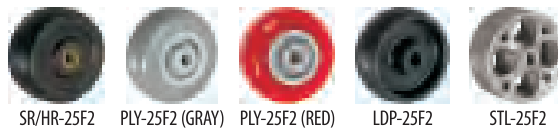

SR/HR-25F2

PLY-25F2 (GRAY)

PLY-25F2 (RED)

LDP-25F2

STL-25F2

### TP4030 SERIES

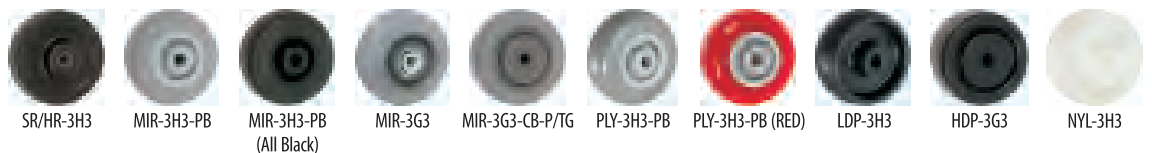

SR/HR-3H3

MIR-3H3-PB

MIR-3H3-PB  
(All Black)

MIR-3G3

MIR-3G3-CB-P/TG

PLY-3H3-PB

PLY-3H3-PB (RED)

LDP-3H3

HDP-3G3

NYL-3H3

### TP4040 SERIES

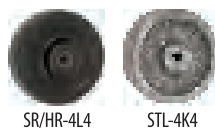

SR/HR-4L4

STL-4K4

# Light-Medium Duty Casters

## TP5000 Series / Capacity up to 350 Lbs.



### Features

- Finish: Bright zinc plating
- Swivel: Double ball bearing raceways
- Rigid: Pressed or welded with heavy duty gauge steel for extra strength  
U-Bracket available (4" & 5" only)
- Construction: Heavy duty gauge steel formed for extra strength
- Axle: 3/8" diameter axle with lock nut
- Applicators: Rubber Expanding Adapters & Pipe Threaded Stems available
- Lower Nut: Standard on Threaded Stem Casters

### Applications

- Bakery & Food Service Equipment
- Institutional, Hotel & Hospital Equipment
- Laboratory Equipment
- L/M duty Material Handling Equipment
- Moving Dollies
- Office & Store Fixtures
- Utility & Maintenance Carts

### Caster Options

- TLB: Top Lock Brake



- SWB: Swivel and Wheel Brake (Total Lock)



- REA: Rubber Expanding Adapter



- PS: Pipe Stem



TP5000 Series



### Fastenings

TYPE	CODE	SIZE (Inch)	
Top Plate	01	Overall Size	2-1/2 x 3-3/4
		Bolt Hole Spacing	1-3/4 x 2-3/4 slotted to 3
		Attaching Bolt Size	5/16
	02	Overall Size	3-3/4 x 4-1/2
		Bolt Hole Spacing	2-5/8 x 3-5/8 slotted to 3 x 3
		Attaching Bolt Size	5/16
03	Overall Size	3-1/8 x 4-1/8	
	Bolt Hole Spacing	1-3/4 x 3 slotted to 2-3/8 x 3/3/8	
	Attaching Bolt Size	5/16	
Grip Ring Stem	11	7/16 x 1-1/2	
	12	0.845 x 2-3/16	
Threaded Stem	21	1/2 - 13 x 1	
	22	1/2 - 13 x 1-1/2	
	23	1/2 - 13 x 2	
	24	1/2 - 13 x 2-1/2	
	25	1/2 - 13 x 2-3/4 (fully threaded)	
	26	1/2 - 13 x 2-3/4 (threaded 1-1/2" from top)	
	29	3/4-10 x 1-1/2	
Round Plain Stem	31	7/8 x 2-3/16 with 5/16 hole cross-drilled	
		0.865 x 1-3/4 with 5/16 hole cross-drilled	
	32	15/16" up from base	
		1 x 2-1/2 with one 5/16 hole drilled	
		9/16 up from base; one 3/8 hole drilled	
33	1-3/16 up from base		
Octagon Stem	41	3/4 x 2-7/16 with 3 (5/16) holes cross-drilled	
Expanding Adapter	CODE	ID of Tube	Size Range
	71	3/4"	0.720" ~ 0.851"
	72	7/8"	0.852" ~ 0.927"
	72A	1"	0.928" ~ 1.029"
	73	1-1/8"	1.030" ~ 1.140"
	74	1-3/16"	1.178" ~ 1.303"
	75	1-3/8"	1.360" ~ 1.425"
	76	1-1/2"	1.426" ~ 1.589"
	77	1-3/4"	1.685" ~ 1.800"
	Pipe Stem	CODE	Threaded Size (NPT)
81		3/4"	PS-81
82		1"	PS-82
83		1-1/4"	PS-83

Replace -\*\*- in part number with appropriate fastening code.

### Options

CODE	DESCRIPTION
CR	Chrome Plating
BR	Bright Brass Plating
SL	Sealed Swivel
TG	Thread Guard (Ball Bearing Wheels)
SWB	Total Lock Swivel Wheel Brake
TLB	Top Lock Brake
REA	Rubber Expanding Adapter
PS	Pipe Stem

Add Option Code to end of part number.

# Light-Medium Duty Casters

Wheel Diameter	Tread Width	Wheel Type	Swivel Number	Rigid Number	Wheel Bearing	Load Capacity	Overall Height	Swivel Radius	
3	1-1/4	Mirage (TPR)	TP5030-**-MIR	TP5030R-**-MIR	Annular	220	4	2-7/8	
		Mirage (TPR)	TP5030-**-MIR-CB	TP5030R-**-MIR-CB	Precision	220			
		Mirage (TPR)	TP5030-**-MIR-PB	TP5030R-**-MIR-PB	Plain	220			
		Soft Rubber	TP5030-**-SR	TP5030R-**-SR	Nylon	150			
		Soft Rubber	TP5030-**-SRB	TP5030R-**-SRB	Ball	150			
		Hard Rubber	TP5030-**-HR	TP5030R-**-HR	Nylon	220			
	1-3/8	Hard Rubber	TP5030-**-HRB	TP5030R-**-HRB	Ball	220			
		Light Duty Plastic	TP5030-**-LDP	TP5030R-**-LDP	Plain	210			
		Heavy Duty Plastic	TP5030-**-HDP	TP5030R-**-HDP	Plain	300			
		Heavy Duty Plastic	TP5030-**-HPB	TP5030R-**-HPB	Ball	300			
		Steel	TP5030-**-STL	TP5030R-**-STL	Plain	300			
	1-1/4	Polyurethane	TP5030-**-PLY	TP5030R-**-PLY	Ball	250			
		Polyurethane	TP5030-**-PLY-CB	TP5030R-**-PLY-CB	Precision	250			
Polyurethane		TP5030-**-PLY-PB	TP5030R-**-PLY-PB	Plain	250				
Solid Polyurethane		TP5030-**-PLX	TP5030R-**-PLX	Precision	300				
High Elastic Polyurethane		TP5030-**-PLE	TP5030R-**-PLE	Precision	125				
3-1/2	1-1/4	Mirage (TPR)	TP5035-**-MIR	TP5035R-**-MIR	Annular	250	4-5/8	3-1/4	
		Mirage (TPR)	TP5035-**-MIR-CB	TP5035R-**-MIR-CB	Precision	250			
		Rubber on Aluminum	TP5035-**-RAL	TP5035R-**-RAL	Annular	250			
		Polyurethane	TP5035-**-PLY-CB	TP5035R-**-PLY-CB	Precision	250			
4	1-1/4	Mirage (TPR)	TP5040-**-MIR	TP5040R-**-MIR	Annular	250	5	3-1/4	
		Mirage (TPR)	TP5040-**-MIR-CB	TP5040R-**-MIR-CB	Precision	250			
		Mirage (TPR)	TP5040-**-MIR-PB	TP5040R-**-MIR-PB	Plain	250			
		Soft Rubber	TP5040-**-SR	TP5040R-**-SR	Nylon	170			
		Soft Rubber	TP5040-**-SRB	TP5040R-**-SRB	Ball	170			
		Hard Rubber	TP5040-**-HR	TP5040R-**-HR	Nylon	255			
		Hard Rubber	TP5040-**-HRB	TP5040R-**-HRB	Ball	255			
		Rubber on Aluminum	TP5040-**-RAL	TP5040R-**-RAL	Annular	250			
		Polyurethane	TP5040-**-PLY	TP5040R-**-PLY	Ball	280			
		Polyurethane	TP5040-**-PLY-CB	TP5040R-**-PLY-CB	Precision	260			
		Polyurethane	TP5040-**-PLY-PB	TP5040R-**-PLY-PB	Plain	260			
		Solid Polyurethane	TP5040-**-PLX	TP5040R-**-PLX	Precision	300			
		High Elastic Polyurethane	TP5040-**-PLE	TP5040R-**-PLE	Precision	165			
	1-15/32	Light Duty Plastic	TP5040-**-LDP	TP5040R-**-LDP	Plain	225			
		Heavy Duty Plastic	TP5040-**-HDP	TP5040R-**-HDP	Plain	275			
		Heavy Duty Plastic	TP5040-**-HPB	TP5040R-**-HPB	Ball	275			
		1-1/4	Steel	TP5040-**-STL	TP5040R-**-STL	Plain			300
			Phenolic	TP5040-**-PHN	TP5040R-**-PHN	Roller			300
				TP5040-**-PHN-PB	TP5040R-**-PHN-PB	Plain			300
			1-1/2	Phenolic Hi-Temp	TP5040-**-PHN-HT	TP5040R-**-PHN-HT			Roller
Phenolic Hi-Temp	TP5040-**-PHN-HT-PB	TP5040R-**-PHN-HT-PB		Plain	300				
Fever Nylon Hi-Temp	TP5040-**-FVR	TP5040R-**-FVR		Roller	300				
Fever Nylon Hi-Temp	TP5040-**-FVR-PB	TP5040R-**-FVR-PB		Plain	300				
Fever-Tech Epoxy Hi-Temp	TP5040-**-FVT	TP5040R-**-FVT		Precision Ball	300				
5	1-1/4	Mirage (TPR)	TP5050-**-MIR	TP5050R-**-MIR	Annular	270	6	4	
		Mirage (TPR)	TP5050-**-MIR-CB	TP5050R-**-MIR-CB	Precision	270			
		Mirage (TPR)	TP5050-**-MIR-PB	TP5050R-**-MIR-PB	Plain	270			
		Soft Rubber	TP5050-**-SR	TP5050R-**-SR	Nylon	200			
		Soft Rubber	TP5050-**-SRB	TP5050R-**-SRB	Ball	200			
		Hard Rubber	TP5050-**-HR	TP5050R-**-HR	Nylon	280			
		Hard Rubber	TP5050-**-HRB	TP5050R-**-HRB	Ball	280			
		Rubber on Aluminum	TP5050-**-RAL	TP5050R-**-RAL	Annular	250			
		Polyurethane	TP5050-**-PLY	TP5050R-**-PLY	Ball	300			
		Polyurethane	TP5050-**-PLY-CB	TP5050R-**-PLY-CB	Precision	300			
		Polyurethane	TP5050-**-PLY-PB	TP5050R-**-PLY-PB	Plain	300			
		Solid Polyurethane	TP5050-**-PLX	TP5050R-**-PLX	Precision	325			
		High Elastic Polyurethane	TP5050-**-PLE	TP5050R-**-PLE	Precision	175			
	1-15/32	Heavy Duty Plastic	TP5050-**-HDP	TP5050R-**-HDP	Plain	300			
		Heavy Duty Plastic	TP5050-**-HPB	TP5050R-**-HPB	Ball	300			
		1-1/2	Phenolic	TP5050-**-PHN	TP5050R-**-PHN	Roller			350
			Phenolic	TP5050-**-PHN-PB	TP5050R-**-PHN-PB	Plain			350
	Phenolic Hi-Temp		TP5050-**-PHN-HT	TP5050R-**-PHN-HT	Roller	350			
	Phenolic Hi-Temp		TP5050-**-PHN-HT-PB	TP5050R-**-PHN-HT-PB	Plain	350			
	Fever Nylon Hi-Temp		TP5050-**-FVR	TP5050R-**-FVR	Roller	350			
	Fever Nylon Hi-Temp	TP5050-**-FVR-PB	TP5050R-**-FVR-PB	Plain	350				

TP5000 Series

# Light-Medium Duty Casters

## Caster Selection Guide for TP5000 Series



TP5030-01-HR  
(2-1/2x 3-3/4)



TP5040-02-PLY-CB (RED)  
(3-1/8 x 4-1/8)



TP5050-03-PLY-TLB (D/B)  
(3-3/4 x 4-1/2)

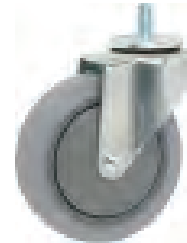

TP5050-21-LN-MIR-CB-P/TG  
(1/2-13x1)



TP5040-22-LN-MIR-SWB  
(1/2-13x 1-1/2")



TP5050-81-LN-PLY-CB-P/TG  
(Pipe Stem)



TP5050-76-LN-HDP-F  
(Rubber Expanding Adapter)



TP5050-31-HDP  
(7/8x 2-3/16)



TP5050-41-PRO  
(3/4x2-7/16)



TP5050-26-LN-MIR-CB  
(1/2-13 x 2-3/4)



TP5040-01-PHN  
T.R. : -45°F~-+250°F



TP5040-01-FVT-BB (HT)  
Temp. Range : 475°F



TP5040-03-FVR-HT-ZA  
Temp. Range : -45°F~-+250°F



TP5050R-01-PLY (RED)  
(2-1/2 x 3-3/4)



TP5050R-03-NYL  
(3-1/8 x 4-1/8)



Rubber Expanding Adapter

TP5000 Series

# Light-Medium Duty Casters

## Wheel Selection Guide for TP5000 & TP5200 Series



HR/SR-5H3



HRB/SRB-4H3



LDP-4H3, 5H3



HDP-3G3



HDP-4K3, 5K3  
(Spoke Type)



HDP-5H3-F  
(Flat Type)



NYL-4H3, 5H3



MIR-3H3-PB

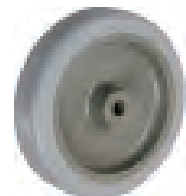

MIR-5H3-PB



MIR-35G3



MIR-3G3-CB-P/TG  
35G3-CB-P/TG  
(Precision Bearing)

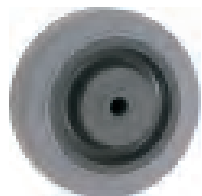

MIR-4G3-CB  
5G3-CB  
(Precision Bearing)



MIR-4G3-CB-P/TG  
MIR-5G3-CB-P/TG  
(Precision Bearing)

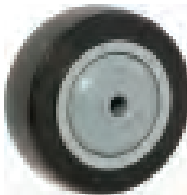

PLY-35G3-CB-P/TG



PLY-3H3-PB

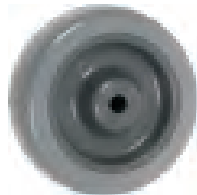

PLY-4H3-PB

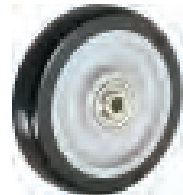

PLY-5J3



PLY-5J3 (RED)

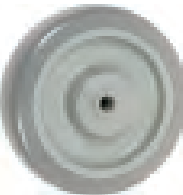

PLY-5J3-CB (GRAY)  
(Precision Bearing)



PLY-5J2-TG  
(Shopping Cart Wheel)

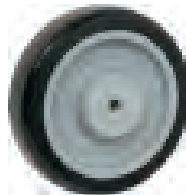

PLY-5J2-CB  
(Shopping Cart Wheel)



PRO-5K0

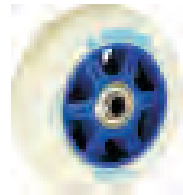

PLE-4H3



PHN-5H5-PB  
T.R.: -45°F~+250°F



PHN-5K0  
T.R.: -45°F~+250°F



PHN-4H5-PB HT  
T.R.: 475°F/550°F

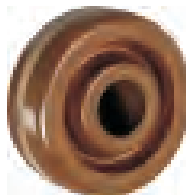

PHN-4K0-HT  
T.R.: 475°F/550°F



FVR-4K5-PB-HT  
T.R.: 475°F/525°F



FVR-4K5-PB-HT (BLACK)  
T.R.: 475°F/525°F



FVT-4K3-PB-HT  
T.R.: 475°F/525°F

TP5000 Series

# Light-Medium Duty Casters

## TP5200 Series / Capacity up to 350 Lbs.



### Features

- Finish: Bright zinc plating or Bright nickel plating
- Swivel: Double ball bearing with hardened raceways for extra strength
- Rigid: Pressed or welded with heavy duty gauge steel for extra strength
- Axle: 3/8" diameter axle with lock nut
- Dust Cover: Helps protect swivel bearings  
Reference TP5201 Series without Dust Cover
- Applicators: Rubber Expanding Adapters & Pipe Threaded Stems available
- Lower Nut: Standard on Threaded Stem Casters

### Applications

- Bakery & Food Service Equipment
- Institutional, Hotel & Hospital Equipment
- Laboratory Equipment
- Material Handling Equipment
- Moving Dollies
- Office & Store Fixtures
- Utility & Maintenance Carts

### Caster Options

- TLB: Top Lock Brake



- FLB: Front Lock Brake



- ZS: Zerk fitting on Swivel Raceway



- PS: Pipe Stem



- Expanding Adapter Stem



TP5200 Series



Fastenings			
TYPE	CODE	SIZE (Inch)	
Top Plate	01	Overall Size	2-3/8 x 3-5/8
		Bolt Hole Spacing	1-3/4 x 2-3/4 slotted to 3
		Attaching Bolt Size	5/16
	02	Overall Size	3-1/8 x 4-1/8
		Bolt Hole Spacing	1-3/4 x 3 slotted to 2-3/8 x 3-3/8
		Attaching Bolt Size	5/16
03	Overall Size	3-3/4 x 4-1/2	
	Bolt Hole Spacing	2-5/8 x 3-5/8 slotted to 3 x 3	
	Attaching Bolt Size	5/16	
Grip Ring Stem	11	7/16 x 1-3/8	
	12	0.845 x 2-3/16	
Threaded Stem	21	1/2 - 13 x 1	
	22	1/2 - 13 x 1-1/2	
	23	1/2 - 13 x 2	
	24	1/2 - 13 x 2-1/2	
	25	1/2 - 13 x 2-3/4 (fully threaded)	
	26	1/2 - 13 x 2-3/4 (threaded 1-1/2" from top)	
	27	5/8-11 x 1-1/2	
	28	5/8-11 x 1	
Hand Truck Stem	33	1 x 2-1/2 with one 5/16 hole drilled 9/16" up from base	
		one 3/8 hole drilled 1-3/16 up from base	
Square Stem	51	0.845 x 2 with 1/4" cross-drilled hole 1" up from base	
	52	7/8 x 2-1/2 with 1/4" cross-drilled hole 1" and 2-1/8 up from base	
Rubber Expanding Adapter	<b>CODE</b>	<b>ID of TUBE</b>	<b>SIZE RANGE</b>
	71	3/4"	0.720" ~ 0.851"
	72	7/8"	0.852" ~ 0.927"
	72A	1"	0.928" ~ 1.029"
	73	1-1/8"	1.030" ~ 1.140"
	74	1-3/16"	1.178" ~ 1.303"
	75	1-3/8"	1.360" ~ 1.425"
	76	1-1/2"	1.426" ~ 1.589"
77	1-3/4"	1.685" ~ 1.800"	
Pipe Stem	<b>CODE</b>	<b>THREADED SIZE</b>	<b>Pipe Socket Only</b>
	81	3/4" PIPE	PS-81
	82	1" PIPE	PS-82
	83	1-1/4" PIPE	PS-83

Replace -\*\* - in part number with appropriate fastening code.

Options	
CODE	DESCRIPTION
CR	Chrome Plating
TG	Thread Guard (Ball Bearing Wheels)
FLB	Front Lock Brake
TLB	Top Lock Brake
ZA	Zerk Axle and NUT
ZS	Zerk fitting on Swivel Raceway

Add Option Code to end of part number.



Wheel Diameter	Tread Width	Wheel Type	Swivel Number	Rigid Number	Wheel Bearing	Load Capacity	Overall Height	Swivel Radius
2	7/8	Twin Hard Rubber	TP5222-**-HR	TP5222R-**-HR	Ball	200	3-3/16	2-1/4
2-1/2	7/8	Twin Hard Rubber	TP5225-**-HR	TP5225R-**-HR	Ball	200	3-13/16	3
3	1-1/4	Mirage (TPR)	TP5230-**-MIR	TP5230R-**-MIR	Annular	220	4-1/8	3
		Mirage (TPR)	TP5230-**-MIR-CB	TP5230R-**-MIR-CB	Precision	220		
		Mirage (TPR)	TP5230-**-MIR-PB	TP5230R-**-MIR-PB	Plain	220		
		Soft Rubber	TP5230-**-SR	TP5230R-**-SR	Nylon	150		
		Hard Rubber	TP5230-**-HR	TP5230R-**-HR	Nylon	220		
		Hard Rubber	TP5230-**-HRB	TP5230R-**-HRB	Ball	220		
	1-15/32	Light Duty Plastic	TP5230-**-LDP	TP5230R-**-LDP	Plain	210		
		Heavy Duty Plastic	TP5230-**-HDP	TP5230R-**-HDP	Plain	300		
	1-1/4	Heavy Duty Plastic	TP5230-**-HPB	TP5230R-**-HPB	Ball	300		
		Steel	TP5230-**-STL	TP5230R-**-STL	Plain	300		
		Polyurethane	TP5230-**-PLY	TP5230R-**-PLY	Ball	250		
		Polyurethane	TP5230-**-PLY-CB	TP5230R-**-PLY-CB	Precision	250		
Polyurethane		TP5230-**-PLY-PB	TP5230R-**-PLY-PB	Plain	250			
		Solid Polyurethane	TP5230-**-PLX	TP5230R-**-PLX	Precision	300		
		High Elastic Polyurethane	TP5230-**-PLE	TP5230R-**-PLE	Precision	125		
3-1/2	1-1/4	Mirage (TPR)	TP5235-**-MIR	TP5235R-**-MIR	Annular	250	4-5/8	3-1/4
		Mirage (TPR)	TP5235-**-MIR-CB	TP5235R-**-MIR-CB	Precision	250		
		Rubber on Aluminum	TP5235-**-RAL	TP5235R-**-RAL	Annular	250		
		Polyurethane	TP5235-**-PLY-CB	TP5235R-**-PLY-CB	Precision	250		
4	1-1/4	Mirage (TPR)	TP5240-**-MIR	TP5240R-**-MIR	Annular	250	5-1/8	3-1/2
		Mirage (TPR)	TP5240-**-MIR-CB	TP5240R-**-MIR-CB	Precision	250		
		Mirage (TPR)	TP5240-**-MIR-PB	TP5240R-**-MIR-PB	Plain	250		
		Soft Rubber	TP5240-**-SR	TP5240R-**-SR	Nylon	175		
		Hard Rubber	TP5240-**-HR	TP5240R-**-HR	Nylon	255		
		Hard Rubber	TP5240-**-HRB	TP5240R-**-HRB	Ball	255		
		Rubber on Aluminum	TP5240-**-RAL	TP5240R-**-RAL	Annular	250		
		Polyurethane	TP5240-**-PLY	TP5240R-**-PLY	Ball	280		
		Polyurethane	TP5240-**-PLY-CB	TP5240R-**-PLY-CB	Precision	280		
		Polyurethane	TP5240-**-PLY-PB	TP5240R-**-PLY-PB	Plain	280		
	1-15/32	Solid Polyurethane	TP5240-**-PLX	TP5240R-**-PLX	Precision	300		
		High Elastic Polyurethane	TP5240-**-PLE	TP5240R-**-PLE	Precision	165		
	1-1/4	Light Duty Plastic	TP5240-**-LDP	TP5240R-**-LDP	Plain	225		
		Heavy Duty Plastic	TP5240-**-HDP	TP5240R-**-HDP	Plain	275		
	1-1/2	Heavy Duty Plastic	TP5240-**-HPB	TP5240R-**-HPB	Ball	275		
		Steel	TP5240-**-STL	TP5240R-**-STL	Plain	300		
		Phenolic	TP5240-**-PHN	TP5240R-**-PHN	Roller	300		
		Phenolic	TP5240-**-PHN-PB	TP5240R-**-PHN-PB	Plain	300		
Phenolic Hi-Temp		TP5240-**-PHN-HT	TP5240R-**-PHN-HT	Roller	300			
Phenolic Hi-Temp		TP5240-**-PHN-HT-PB	TP5240R-**-PHN-HT-PB	Plain	300			
5	1-1/4	Mirage (TPR)	TP5250-**-MIR	TP5250R-**-MIR	Annular	270	6-1/4	4
		Mirage (TPR)	TP5250-**-MIR-CB	TP5250R-**-MIR-CB	Precision	270		
		Mirage (TPR)	TP5250-**-MIR-PB	TP5250R-**-MIR-PB	Plain	270		
		Soft Rubber	TP5250-**-SR	TP5250R-**-SR	Nylon	200		
		Soft Rubber	TP5250-**-SRB	TP5250R-**-SRB	Ball	200		
		Hard Rubber	TP5250-**-HR	TP5250R-**-HR	Nylon	280		
		Hard Rubber	TP5250-**-HRB	TP5250R-**-HRB	Ball	280		
		Rubber on Aluminum	TP5250-**-RAL	TP5250R-**-RAL	Annular	250		
		Polyurethane	TP5250-**-PLY	TP5250R-**-PLY	Ball	300		
		Polyurethane	TP5250-**-PLY-CB	TP5250R-**-PLY-CB	Precision	300		
	Polyurethane	TP5250-**-PLY-PB	TP5250R-**-PLY-PB	Plain	300			
	1-15/32	Solid Polyurethane	TP5250-**-PLX	TP5250R-**-PLX	Precision	300		
		High Elastic Polyurethane	TP5250-**-PLE	TP5250R-**-PLE	Precision	175		
		Heavy Duty Plastic	TP5250-**-HDP	TP5250R-**-HDP	Plain	300		
Heavy Duty Plastic		TP5250-**-HPB	TP5250R-**-HPB	Ball	300			
1-1/2	Phenolic	TP5250-**-PHN	TP5250R-**-PHN	Roller	300			
6	1-1/4	Mirage (TPR)	TP5260-**-MIR	TP5260R-**-MIR	Annular	300	7-1/4	4-1/2
		Mirage (TPR)	TP5260-**-MIR-CB	TP5260R-**-MIR-CB	Precision	300		
		Mirage (TPR)	TP5260-**-MIR-PB	TP5260R-**-MIR-PB	Plain	300		
		Soft Rubber	TP5260-**-SR	TP5260R-**-SR	Nylon	220		
		Soft Rubber	TP5260-**-SRB	TP5260R-**-SRB	Ball	220		
		Hard Rubber	TP5260-**-HR	TP5260R-**-HR	Nylon	300		
		Hard Rubber	TP5260-**-HRB	TP5260R-**-HRB	Ball	300		
		Polyurethane	TP5260-**-PLY	TP5260R-**-PLY	Ball	300		
		Polyurethane	TP5260-**-PLY-CB	TP5260R-**-PLY-CB	Precision	300		
		Polyurethane	TP5260-**-PLY-PB	TP5260R-**-PLY-PB	Plain	300		
	1-15/32	Heavy Duty Plastic	TP5260-**-HDP	TP5260R-**-HDP	Plain	360		
		Heavy Duty Plastic	TP5260-**-HPB	TP5260R-**-HPB	Ball	360		
	1-1/2	Phenolic	TP5260-**-PHN	TP5260R-**-PHN	Roller	360		

**TP5200 Series**

# Light-Medium Duty Casters

## Caster Selection Guide for TP5200 Series



TP5225-01-NRB



TP5222R-01-NRB



TP5235-02-PLY-CB-FLB



TP5240-03-FVT-ZS



TP5250R-01-MIR-PB



TP5251R-01-PLY (RED)



TP5252R-02-HDP-F  
(U-Bracket Type)



TP5250-11-MIR-TLB  
7/16 X 1-3/8"



TP5250-12-PLY-M/TG-TLB  
0.845 X 2



TP5250-22-MIR-P/TG-FLB  
1/2-13 x 1-1/2



TP5250-28-HDP-F  
5/8-11 x 1



TP5250-76-MIR-CD  
(Rubber Expanding Adapter)



TP5250-33-PLY-CB  
(Hand Truck Caster)



TP5250-51-PRO  
(0.845 x 2")

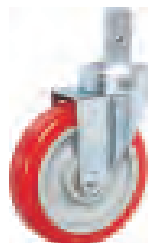

TP5250-52-PLY (RED)  
7/8 X 2-1/2



TP5250-81-MIR-CB-P/TG  
Pipe Stem

TP5200 Series

# Medium Duty Casters

## TP5800 Series / Capacity up to 450 Lbs.



### Features

- Finish: Bright zinc plating or Bright nickel plating
- Swivel: Double ball bearing with hardened raceways for extra strength
- Rigid: Pressed or welded with heavy duty gauge street for extra strength
- Axle: Wheel size 4" & 5" use 3/8" diameter axle with lock nut  
Wheel size 6" use 1/2" diameter axle with lock nut
- Dust Cover: Helps protect swivel bearings  
Reference TP5201 Series without Dust Cover
- Applicators: Rubber Expanding Adapters & Pipe Threaded Stems available
- Lower Nut: Standard on Threaded Stem Casters

### Applications

- Food Service
- Hospital Equipment
- Institutional Equipment
- Office Equipment
- Utility Carts
- Warehouse Nurseries

### Caster Options

- TLB: Top Lock Brake



Wheel Diameter	Tread Width	Wheel Type	Swivel Number	Rigid Number	Wheel Bearing	Load Capacity	Overall Height	Swivel Radius
4	1-1/2	Phenolic	TP5840-**-PHN	TP5840R-**-PHN	Roller	400	5-3/8	3-1/2
		Mirage (TPR)	TP5840-**-MIR	TP5840R-**-MIR	Roller	350		
		Pro-Tech Polyurethane	TP5840-**-PRO	TP5840R-**-PRO	Roller	400		
5	1-1/2	Phenolic	TP5850-**-PHN	TP5850R-**-PHN	Roller	400	6-1/4	4
		Mirage (TPR)	TP5850-**-MIR	TP5850R-**-MIR	Roller	380		
		Pro-Tech Polyurethane	TP5850-**-PRO	TP5850R-**-PRO	Roller	420		
6	1-1/2	Phenolic	TP5860-**-PHN	TP5860R-**-PHN	Roller	400	7-1/2	4-3/4
		Mirage (TPR)	TP5860-**-MIR	TP5860R-**-MIR	Roller	400		
		Pro-Tech Polyurethane	TP5860-**-PRO	TP5860R-**-PRO	Roller	440		
8	1-1/2	Mirage (TPR)	TP5860-**-MIR	TP5860R-**-MIR	Roller	420	9-1/2	6-1/2
		Pro-Tech Polyurethane	TP5860-**-PRO	TP5860R-**-PRO	Roller	450		

Fastenings			
TYPE	CODE	SIZE (Inch)	
Top Plate	01	Overall Size	2-3/8 x 3-5/8
		Bolt Hole Spacing	1-3/4 x 2-3/4 slotted to 3
		Attaching Bolt Size	5/16
	02	Overall Size	3-1/8 x 4-1/8
		Bolt Hole Spacing	1-3/4 x 3 slotted to 2-3/8 x 3-3/8
		Attaching Bolt Size	5/16
03	Overall Size	3-3/4 x 4-1/2	
	Bolt Hole Spacing	2-5/8 x 3-5/8 slotted to 3 x 3	
	Attaching Bolt Size	5/16	
Grip Ring Stem	12	0.845 x 2-3/16	
Threaded Stem	21	1/2 - 13 x 1	
	22	1/2 - 13 x 1-1/2	
Round Plain Stem	31	7/8 x 2-3/16 with 5/16 hole 15/16" up from base	
	32	0.865 x 1-3/4 with 5/16 hole 15/16" up from base	
Expanding Adapter	<b>CODE</b>	<b>ID of Tube</b>	<b>Size Range</b>
	71	3/4"	0.720" ~ 0.851"
	72	7/8"	0.852" ~ 0.927"
	72A	1"	0.928" ~ 1.029"
	73	1-1/8"	1.030" ~ 1.140"
	74	1-3/16"	1.178" ~ 1.303"
	75	1-3/8"	1.360" ~ 1.425"
	76	1-1/2"	1.426" ~ 1.589"
77	1-3/4"	1.685" ~ 1.800"	

Replace -\*\*- in part number with appropriate fastening code.

Options	
CODE	DESCRIPTION
TLB	Top Lock Brake

Add Option Code to end of part number.

### Wheel Options



TP5800 Series

# Medium Duty Casters

## TP6200 Series / Capacity up to 550 Lbs. each



### Features

- Finish: Bright zinc plating
- Swivel: Double ball bearing with hardened raceways for extra strength
- Rigid: Welded with heavy duty gauge street for extra strength
- Fork Leg Spacing: 2"
- Grease Fittings: Grease hole in lower raceway cup
- Axle: 1/2" diameter zerx axle with lock nut

### Applications

- Medium Duty Platform Truck
- Bread Racks
- Food Service Equipment
- Warehouse Carts

### Caster Options

- TLB: Top Lock Brake



TP6200 Series

Wheel Diameter	Tread Width	Wheel Type	Swivel Number	Rigid Number	Wheel Bearing	Load Capacity	Overall Height	Swivel Radius
4	1-1/2	Rubber / Cast Iron	TP6240-**-RCI	TP6240R-**-RCI	Roller	250	5-5/16	3-3/8
		Pro-Tech Polyurethane	TP6240-**-PRO	TP6240R-**-PRO	Roller	400		
		Polyurethane / Cast Iron	TP6240-**-PCI	TP6240R-**-PCI	Roller	450		
		Heavy Duty Plastic	TP6240-**-HPB	TP6240R-**-HPB	Ball	450		
		Phenolic	TP6240-**-PHN	TP6240R-**-PHN	Roller	450		
5	1-1/2	Rubber / Cast Iron	TP6250-**-RCI	TP6250R-**-RCI	Roller	350	6-5/16	4-1/8
		Pro-Tech Polyurethane	TP6250-**-PRO	TP6250R-**-PRO	Roller	500		
		Polyurethane / Cast Iron	TP6250-**-PCI	TP6250R-**-PCI	Roller	500		
		Heavy Duty Plastic	TP6250-**-HPB	TP6250R-**-HPB	Ball	500		
		Phenolic	TP6250-**-PHN	TP6250R-**-PHN	Roller	500		
6	1-1/2	Rubber / Cast Iron	TP6260-**-RCI	TP6260R-**-RCI	Roller	450	7-1/2	4-5/8
		Pro-Tech Polyurethane	TP6260-**-PRO	TP6260R-**-PRO	Roller	550		
		Polyurethane / Cast Iron	TP6260-**-PCI	TP6260R-**-PCI	Roller	550		
		PlexSolid Polyurethane	TP6260-**-PLX	TP6260R-**-PLX	Roller	550		
		Heavy Duty Plastic	TP6260-**-HDP	TP6260R-**-HDP	Plain	550		
		Phenolic	TP6260-**-PHN	TP6260R-**-PHN	Roller	550		

Fastenings			
TYPE	CODE	SIZE (Inch)	
Top Plate	01	Overall Size	3-3/8 x 3-13/16
		Bolt Hole Spacing	2-9/32 x3 to 3-19/32 x 2-11/16
		Attaching Bolt Size	3/8
Top Plate	02	Overall Size	4 x 4-1/2
		Bolt Hole Spacing	2-5/8 x 3-5/8 slotted to 3 x 3
		Attaching Bolt Size	3/8
Threaded Stem	21	5/8 - 11 x 2	

Replace -\*\* - in part number with appropriate fastening code.

Options	
CODE	DESCRIPTION
TLB	Top Lock Brake
TG	Thread Guard (Ball Bearing Wheels)

Add Option Code to end of part number.

### Wheel Options

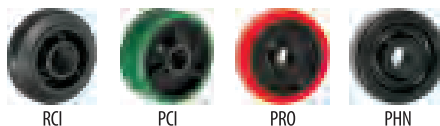

# Medium Duty Casters

## TP6400 Series / Capacity up to 800 Lbs.



### Features

- Finish: Bright zinc plating
- Swivel: Double ball bearing with hardened raceways for extra strength
- Rigid: Welded with heavy duty gauge street for extra strength
- Fork Leg Spacing: 2"
- Grease Fittings: Provided in swivel raceway and wheel bearings
- Axle: 1/2" diameter zerk axle with lock nut

### Applications

- Food Service Equipment
- Medium Duty Appliances
- Medium Duty Platform Truck
- Warehouse Stock Carts
- Wire Shelving Units

### Caster Options

- TLB: Top Lock Brake



Wheel Diameter	Tread Width	Wheel Type	Swivel Number	Rigid Number	Wheel Bearing	Load Capacity	Overall Height	Swivel Radius
4	1-1/2	Rubber / Cast Iron	TP6440-**-RCI	TP6440R-**-RCI	Roller	250	5-5/8	3-9/16
		Pro-Tech Polyurethane	TP6440-**-PRO	TP6440R-**-PRO	Roller	500		
		Polyurethane / Cast Iron	TP6440-**-PCI	TP6440R-**-PCI	Roller	600		
		Plex Solid Polyurethane	TP6440-**-PLX	TP6440R-**-PLX	Roller	500		
		Heavy Duty Plastic	TP6440-**-HDP	TP6440R-**-HDP	Plain	500		
		Heavy Duty Plastic	TP6440-**-HPB	TP6440R-**-HPB	Ball	500		
		Phenolic	TP6440-**-PHN	TP6440R-**-PHN	Roller	600		
		Hi-Temp Phenolic	TP6440-**-PHN-HT	TP6440R-**-PHN-HT	Roller	600		
Fever Hi-Temp	TP6440-**-FVR	TP6440R-**-FVR	Roller	500				
5	1-1/2	Rubber / Cast Iron	TP6450-**-RCI	TP6450R-**-RCI	Roller	350	6-1/2	4-1/4
		Pro-Tech Polyurethane	TP6450-**-PRO	TP6450R-**-PRO	Roller	600		
		Polyurethane / Cast Iron	TP6450-**-PCI	TP6450R-**-PCI	Roller	700		
		Plex Solid Polyurethane	TP6450-**-PLX	TP6450R-**-PLX	Roller	600		
		Heavy Duty Plastic	TP6450-**-HDP	TP6450R-**-HDP	Plain	700		
		Heavy Duty Plastic	TP6450-**-HPB	TP6450R-**-HPB	Ball	700		
		Phenolic	TP6450-**-PHN	TP6450R-**-PHN	Roller	700		
		Fever Hi-Temp	TP6450-**-FVR	TP6450R-**-FVR	Roller	600		
6	1-1/2	Rubber / Cast Iron	TP6460-**-RCI	TP6460R-**-RCI	Roller	450	7-3/8	5
		Pro-Tech Polyurethane	TP6460-**-PRO	TP6460R-**-PRO	Roller	700		
		Polyurethane / Cast Iron	TP6460-**-PCI	TP6460R-**-PCI	Roller	800		
		Plex Solid Polyurethane	TP6460-**-PLX	TP6460R-**-PLX	Roller	700		
		Heavy Duty Plastic	TP6460-**-HDP	TP6460R-**-HDP	Plain	800		
		Heavy Duty Plastic	TP6460-**-HPB	TP6460R-**-HPB	Ball	800		
		Phenolic	TP6460-**-PHN	TP6460R-**-PHN	Roller	800		
		Fever Hi-Temp	TP6460-**-FVR	TP6460R-**-FVR	Roller	700		

### TP64 Fastenings

TYPE	CODE	SIZE (Inch)	
Top Plate	01	Overall Size	4-1/2 x 6-1/4
		Bolt Hole Spacing	2-7/16 x 4-15/16 slotted to 3-3/8 x 5-1/4
		Attaching Bolt Size	1/2"

Replace -\*\*- in part number with appropriate fastening code.

### Options

CODE	DESCRIPTION
TLB	Top Lock Brake
PSL	4 Position Swivel Lock
DW	Double Welded Legs
SL	Sealed Swivel
TG	Thread Guard

Add Option Code to end of part number.

### Wheel Options

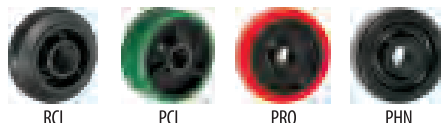

RCI PCI PRO PHN

TP6400 Series

# Medium-Heavy Duty Casters

## TP6600 Series / Capacity up to 1250 Lbs.



### Features

- Finish: Bright zinc plating
- Swivel: Double ball bearing with hardened raceways for extra strength
- Rigid: Welded with heavy duty gauge street for extra strength
- Fork Leg Spacing: 2-1/2"
- Construction: 1/4" thick top plate and legs for additional strength
- King Pin: 5/8" diameter bolt and nut
- Grease Fittings: Provided in swivel raceway and wheel bearings
- PSL-Notched: All swivel rigs notched for optional 4-Position swivel lock
- Axle: 1/2" diameter axle with lock nut

### Applications

- Material Handling
- Mobile Storage Racks
- Mobile Tool Chests
- Platform Carts
- Warehouse Trucks

### Caster Options

- TLB: Top Lock Brake



- FLB: Front Lock Brake



- CLB: Cam Lock Brake



- RLB: Rigid Lock Brake



- PSL-4: WELDED



- PSL-4 (Attach type)



- PSL-4: O-Ring



TP6600 Series

### Fastenings

TYPE	CODE	SIZE (Inch)	
Top Plate	01	Overall Size	4 x 4-1/2
		Bolt Hole Spacing	2-5/8 x 3-5/8 slotted to 3 x 3
		Attaching Bolt Size	3/8
	04	Overall Size	5 x 5-1/2
		Bolt Hole Spacing	4-1/8 x 4-1/2
		Attaching Bolt Size	3/8"
	07	Overall Size	4-1/2 x 6-1/4
		Bolt Hole Spacing	2-7/16 x 4-15/16 slotted to 3-3/8 x 5-1/4
		Attaching Bolt Size	1/2"
Threaded Stem	21	5/8 - 11 x 2	

Replace -\*\* - in part number with appropriate fastening code.

### Options

CODE	DESCRIPTION
TLB	Top Lock Brake
FLB	Front Lock Brake
CLB	Cam Lock Brake
RLB	Rigid Lock Brake (TP6680R Only)
PSL	4 Position Swivel Lock
DW	Double Welded Legs
SL	Sealed Swivel
TG	Thread Guard

Add Option Code to end of part number.

# Medium-Heavy Duty Casters

## TP6600 Series / Capacity up to 1250 Lbs.

Wheel Diameter	Tread Width	Wheel Type	Swivel Number	Rigid Number	Wheel Bearing	Load Capacity	Overall Height	Swivel Radius
4	2	Mirage (TPR)	TP6640-**-MIR	TP6640R-**-MIR	Roller	350	5-5/8	3-9/16
		Crown Mirage (TPR)	TP6640-**-MRC	TP6640R-**-MRC	Roller	350		
		Rubber / Cast Iron	TP6640-**-RCI	TP6640R-**-RCI	Roller	400		
		Rubber / Nylon	TP6640-**-RNY	TP6640R-**-RNY	Roller	400		
		Pro-Tech Polyurethane	TP6640-**-PRO	TP6640R-**-PRO	Roller	500		
		Pro-Tech Xtra	TP6640-**-PRX	TP6640R-**-PRX	Precision	700		
		Polyurethane / Cast Iron	TP6640-**-PCI	TP6640R-**-PCI	Roller	800		
		Plex Solid Polyurethane	TP6640-**-PLX	TP6640R-**-PLX	Roller	700		
		Nylon Glass-Filled	TP6640-**-NGF	TP6640R-**-NGF	Roller	800		
		Heavy Duty Plastic	TP6640-**-HPR	TP6640R-**-HPR	Roller	450		
		Phenolic	TP6640-**-PHN	TP6640R-**-PHN	Roller	800		
		Hi-Temp Phenolic	TP6640-**-PHN-HT	TP6640R-**-PHN-HT	Roller	800		
		Steel	TP6640-**-STL	TP6640R-**-STL	Roller	800		
V-Groove Steel	TP6640-**-VGR	TP6640R-**-VGR	Roller	700				
5	2	Mirage (TPR)	TP6650-**-MIR	TP6650R-**-MIR	Roller	400	6-1/2	4-1/4
		Crown Mirage (TPR)	TP6650-**-MRC	TP6650R-**-MRC	Roller	400		
		Rubber / Cast Iron	TP6650-**-RCI	TP6650R-**-RCI	Roller	450		
		Rubber / Nylon	TP6650-**-RNY	TP6650R-**-RNY	Roller	450		
		Pro-Tech Polyurethane	TP6650-**-PRO	TP6650R-**-PRO	Roller	600		
		Pro-Tech Xtra	TP6650-**-PRX	TP6650R-**-PRX	Precision	800		
		Polyurethane / Cast Iron	TP6650-**-PCI	TP6650R-**-PCI	Roller	1000		
		Plex Solid Polyurethane	TP6650-**-PLX	TP6650R-**-PLX	Roller	800		
		Polyurethane / Nylon	TP6650-**-PNY	TP6650R-**-PNY	Roller	1000		
		Nylon Glass-Filled	TP6650-**-NGF	TP6650R-**-NGF	Roller	1000		
		Heavy Duty Plastic	TP6650-**-HPR	TP6650R-**-HPR	Roller	550		
		Phenolic	TP6650-**-PHN	TP6650R-**-PHN	Roller	1000		
		Fever Hi-Temp	TP6650-**-FVR	TP6650R-**-FVR	Roller	1000		
Steel	TP6650-**-STL	TP6650R-**-STL	Roller	1000				
6	2	Mirage (TPR)	TP6660-**-MIR	TP6660R-**-MIR	Roller	500	7-1/2	4-1/2
		Crown Mirage (TPR)	TP6660-**-MRC	TP6660R-**-MRC	Roller	500		
		Rubber / Cast Iron	TP6660-**-RCI	TP6660R-**-RCI	Roller	550		
		Rubber / Aluminum	TP6660-**-RAL	TP6660R-**-RAL	Roller	450		
		Rubber / Nylon	TP6660-**-RNY	TP6660R-**-RNY	Roller	550		
		Pro-Tech Polyurethane	TP6660-**-PRO	TP6660R-**-PRO	Roller	720		
		Pro-Tech Xtra	TP6660-**-PRX	TP6660R-**-PRX	Precision	1000		
		Polyurethane / Cast Iron	TP6660-**-PCI	TP6660R-**-PCI	Roller	1200		
		Polyurethane / Aluminum	TP6660-**-PAL	TP6660R-**-PAL	Roller	1000		
		Plex Solid Polyurethane	TP6660-**-PLX	TP6660R-**-PLX	Roller	900		
		Polyurethane / Nylon	TP6660-**-PNY	TP6660R-**-PNY	Roller	1200		
		Nylon Glass-Filled	TP6660-**-NGF	TP6660R-**-NGF	Roller	1200		
		Heavy Duty Plastic	TP6660-**-HPR	TP6660R-**-HPR	Roller	650		
Phenolic	TP6660-**-PHN	TP6660R-**-PHN	Roller	1200				
Fever Hi-Temp	TP6660-**-FVR	TP6660R-**-FVR	Roller	1200				
Steel	TP6660-**-STL	TP6660R-**-STL	Roller	1200				
8	2	Mirage (TPR)	TP6680-**-MIR	TP6680R-**-MIR	Roller	600	9-1/2	6-1/2
		Crown Mirage (TPR)	TP6680-**-MRC	TP6680R-**-MRC	Roller	600		
		Rubber / Cast Iron	TP6680-**-RCI	TP6680R-**-RCI	Roller	600		
		Rubber / Nylon	TP6680-**-RNY	TP6680R-**-RNY	Roller	600		
		Pro-Tech Polyurethane	TP6680-**-PRO	TP6680R-**-PRO	Roller	1000		
		Pro-Tech Xtra	TP6680-**-PRX	TP6680R-**-PRX	Precision	1000		
		Polyurethane / Cast Iron	TP6680-**-PCI	TP6680R-**-PCI	Roller	1250		
		Polyurethane / Aluminum	TP6680-**-PAL	TP6680R-**-PAL	Roller	1200		
		Plex Solid Polyurethane	TP6680-**-PLX	TP6680R-**-PLX	Roller	1000		
		Polyurethane / Nylon	TP6680-**-PNY	TP6680R-**-PNY	Roller	1250		
		Nylon Glass-Filled	TP6680-**-NGF	TP6680R-**-NGF	Roller	1250		
		Heavy Duty Plastic	TP6680-**-HPR	TP6680R-**-HPR	Roller	850		
		Phenolic	TP6680-**-PHN	TP6680R-**-PHN	Roller	1250		
Fever Hi-Temp	TP6680-**-FVR	TP6680R-**-FVR	Roller	1250				
Steel	TP6680-**-STL	TP6680R-**-STL	Roller	1250				

TP6600 Series

# Medium-Heavy Duty Casters

## Wheel Options for TP6600 & TP6800 & 7000 Series



RCI



RNY



PCI  
(GREEN)



PCI  
(RED/SILVER)



PNY



STL



VGR



MIR

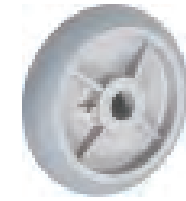

MRC



PRX  
(RED)



PRX  
(BLUE)



PRX  
(BLACK)



PRO  
(RED)



PRO  
(BLUEGREEN)



PRO  
(MAROON)



PLX



RAL

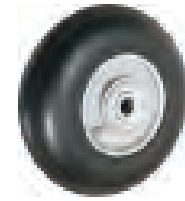

RND  
(BLACK)

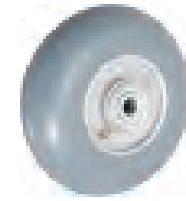

RND  
(GRAY)

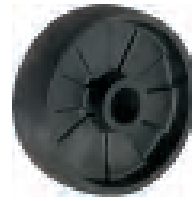

NGF



PHN



PHN-HT



RTR



HPR



HDP

TP6600 Series



# Medium-Heavy Duty Casters

## TP6800 Series / Capacity up to 1400 Lbs.



### Features

- Finish: Bright zinc plating
- Swivel: Double ball bearing with hardened raceways for extra strength
- Rigid: Welded with heavy duty gauge street for extra strength
- Fork Spacing: 2-1/2"
- Construction: Large top plate and raceway combine ease of swiveling and strength
- Grease Fittings: Zerk in swivel section
- PSL-Notched: All swivel rigs notched for optional 4-Position swivel lock
- Axle: 1/2" diameter axle with lock nut

### Applications

- Cargo Container
- Freight Terminal Trucks
- Material Handling Cart
- Large Platform Trucks

### Caster Options

- TLB: Top Lock Brake



Fastening			
TYPE	CODE	SIZE (Inch)	
Top Plate	01	Overall Size	4-1/2 x 6-1/4
		Bolt Hole Spacing	2-7/16 x 4-15/16 slotted to 3-3/8 x 5-1/4
		Attaching Bolt Size	1/2"

Replace -\*\*- in part number with appropriate fastening code.

Options	
CODE	DESCRIPTION
TLB	Top Lock Brake
PSL	4 Position Swivel Lock
DW	Double Welded Legs
SL	Sealed Swivel
TG	Thread Guard

Add Option Code to end of part number.

### Wheel Options



RCI

PCI

PRO (RED)

TP6800 Series

# Medium-Heavy Duty Casters

## TP6800 Series / Capacity up to 1400 Lbs.

**TP6800 Series**

Wheel Diameter	Tread Width	Wheel Type	Swivel Number	Rigid Number	Wheel Bearing	Load Capacity	Overall Height	Swivel Radius
4	2	Mirage (TPR)	TP6840-01-MIR	TP6840R-01-MIR	Roller	350	5-5/8	3-13/16
		Crown Mirage (TPR)	TP6840-01-MRC	TP6840R-01-MRC	Roller	350		
		Rubber / Cast Iron	TP6840-01-RCI	TP6840R-01-RCI	Roller	400		
		Rubber / Nylon	TP6840-01-RNY	TP6840R-01-RNY	Roller	400		
		Pro-Tech Polyurethane	TP6840-01-PRO	TP6840R-01-PRO	Roller	500		
		Pro-Tech Xtra	TP6840-01-PRX	TP6840R-01-PRX	Precision	700		
		Polyurethane / Cast Iron	TP6840-01-PCI	TP6840R-01-PCI	Roller	800		
		Plex Solid Polyurethane	TP6840-01-PLX	TP6840R-01-PLX	Roller	700		
		Polyurethane / Nylon	TP6840-01-PNY	TP6840R-01-PNY	Roller	700		
		Nylon Glass-Filled	TP6840-01-NGF	TP6840R-01-NGF	Roller	800		
		Heavy Duty Plastic	TP6840-01-HPR	TP6840R-01-HPR	Roller	800		
		Phenolic	TP6840-01-PHN	TP6840R-01-PHN	Roller	800		
		Steel	TP6840-01-STL	TP6840R-01-STL	Roller	700		
5	2	Mirage (TPR)	TP6850-01-MIR	TP6850R-01-MIR	Roller	400	6-1/2	4
		Crown Mirage (TPR)	TP6850-01-MRC	TP6850R-01-MRC	Roller	400		
		Rubber / Cast Iron	TP6850-01-RCI	TP6850R-01-RCI	Roller	450		
		Rubber / Nylon	TP6850-01-RNY	TP6850R-01-RNY	Roller	450		
		Pro-Tech Polyurethane	TP6850-01-PRO	TP6850R-01-PRO	Roller	600		
		Pro-Tech Xtra	TP6850-01-PRX	TP6850R-01-PRX	Precision	800		
		Polyurethane / Cast Iron	TP6850-01-PCI	TP6850R-01-PCI	Roller	1000		
		Plex Solid Polyurethane	TP6850-01-PLX	TP6850R-01-PLX	Roller	800		
		Polyurethane / Nylon	TP6850-01-PNY	TP6850R-01-PNY	Roller	1000		
		Nylon Glass-Filled	TP6850-01-NGF	TP6850R-01-NGF	Roller	800		
		Heavy Duty Plastic	TP6850-01-HPR	TP6850R-01-HPR	Roller	800		
		Phenolic	TP6850-01-PHN	TP6850R-01-PHN	Roller	1000		
		Steel	TP6850-01-STL	TP6850R-01-STL	Roller	800		
6	2	Mirage (TPR)	TP6860-01-MIR	TP6860R-01-MIR	Roller	500	7-1/2	4-3/4
		Crown Mirage (TPR)	TP6860-01-MRC	TP6860R-01-MRC	Roller	500		
		Rubber / Cast Iron	TP6860-01-RCI	TP6860R-01-RCI	Roller	550		
		Rubber / Nylon	TP6860-01-RNY	TP6860R-01-RNY	Roller	550		
		Pro-Tech Polyurethane	TP6860-01-PRO	TP6860R-01-PRO	Roller	720		
		Pro-Tech Xtra	TP6860-01-PRX	TP6860R-01-PRX	Precision	1000		
		Polyurethane / Cast Iron	TP6860-01-PCI	TP6860R-01-PCI	Roller	1200		
		Plex Solid Polyurethane	TP6860-01-PLX	TP6860R-01-PLX	Roller	900		
		Polyurethane / Nylon	TP6860-01-PNY	TP6860R-01-PNY	Roller	1200		
		Nylon Glass-Filled	TP6860-01-NGF	TP6860R-01-NGF	Roller	1000		
		Heavy Duty Plastic	TP6860-01-HPR	TP6860R-01-HPR	Roller	1200		
		Phenolic	TP6860-01-PHN	TP6860R-01-PHN	Roller	1200		
		Steel	TP6860-01-STL	TP6860R-01-STL	Roller	1200		
8	2	Mirage (TPR)	TP6880-01-MIR	TP6880R-01-MIR	Roller	600	9-3/4	6-1/4
		Crown Mirage (TPR)	TP6880-01-MRC	TP6880R-01-MRC	Roller	600		
		Rubber / Cast Iron	TP6880-01-RCI	TP6880R-01-RCI	Roller	600		
		Rubber / Nylon	TP6880-01-RNY	TP6880R-01-RNY	Roller	600		
		Pro-Tech Polyurethane	TP6880-01-PRO	TP6880R-01-PRO	Roller	800		
		Pro-Tech Xtra	TP6880-01-PRX	TP6880R-01-PRX	Precision	1200		
		Polyurethane / Cast Iron	TP6880-01-PCI	TP6880R-01-PCI	Roller	1400		
		Plex Solid Polyurethane	TP6880-01-PLX	TP6880R-01-PLX	Roller	1000		
		Polyurethane / Nylon	TP6880-01-PNY	TP6880R-01-PNY	Roller	1400		
		Nylon Glass-Filled	TP6880-01-NGF	TP6880R-01-NGF	Roller	1200		
		Heavy Duty Plastic	TP6880-01-HPR	TP6880R-01-HPR	Roller	1400		
		Phenolic	TP6880-01-PHN	TP6880R-01-PHN	Roller	1400		
		Steel	TP6880-01-STL	TP6880R-01-STL	Roller	1400		

# Heavy Duty Casters

## TP6900 Series / Capacity up to 1800 Lbs.



### Features

- Finish: Bright zinc plating
- Swivel: Double ball bearing with hardened raceways for extra strength
- Rigid: Welded with heavy duty gauge street for extra strength
- Fork Spacing: 3"
- Construction: Large top plate and raceway combine ease of swiveling and strength
- Legs: - HD - 23/64" Thickness  
- 01 - 15/64" Thickness
- Kingpin: 3/4" diameter bolt and nut
- Grease Fittings: Zerk in swivel section
- Axle: - HD - 3/4" diameter axle with lock nut  
- 01 - 1/2" diameter axle with lock nut

### Applications

- Cargo Container
- Freight Terminal Trucks
- Material Handling Cart
- Large Platform Trucks

### Caster Options

- WB: Top Lock Brake
- PSL: 4-Position Swivel Lock

Wheel Diameter	Tread Width	Wheel Type	Swivel Number	Rigid Number	Wheel Bearing	Load Capacity	Overall Height	Swivel Radius
6	2-1/2	Rubber / Cast Iron	TP6960-HD-RCI	TP6960R-HD-RCI	Roller	700	7-1/2	4-3/4
		Polyurethane / Cast Iron	TP6960-HD-PCI	TP6960R-HD-PCI	Roller	1500		
		Phenolic	TP6960-HD-PHN	TP6960R-HD-PHN	Roller	1500		
		Steel	TP6960-HD-STL	TP6960R-HD-STL	Roller	1500		
8	2-1/2	Rubber / Cast Iron	TP6980-HD-RCI	TP6980R-HD-RCI	Roller	850	9-3/4	6-1/4
		Polyurethane / Cast Iron	TP6980-HD-PCI	TP6980R-HD-PCI	Roller	1600		
		Phenolic	TP6980-HD-PHN	TP6980R-HD-PHN	Roller	1600		
		Steel	TP6980-HD-STL	TP6980R-HD-STL	Roller	1600		
10	2-1/2	Rubber / Cast Iron	TP6910-HD-RCI	TP6910R-HD-RCI	Roller	950	11-1/2	7-3/8
		Polyurethane / Cast Iron	TP6910-HD-PCI	TP6910R-HD-PCI	Roller	1800		
		Phenolic	TP6910-HD-PHN	TP6910R-HD-PHN	Roller	1800		
		Steel	TP6910-HD-STL	TP6910R-HD-STL	Roller	1800		

Fastening			
TYPE	CODE	SIZE (Inch)	
Top Plate	-01 - -	Overall Size	4-1/2 x 6-1/4
	HD-	Bolt Hole Spacing	2-7/16 x 4-15/16 slotted to 3-3/8 x 5-1/4
		Attaching Bolt Size	1/2"

Options	
CODE	DESCRIPTION
WB	Wheel Brake

Add Option Code to end of part number.

TP6900 Series

# Heavy Duty Casters

## TP7000 Series / Capacity up to 1400 Lbs.



### Features

- Finish: Bright zinc plating
- Top Plate: 3/8" AISI 1045 drop forged steel for maximum strength
- Swivel: Double ball bearing coined "deep-groove" load and machined component trust raceway
- Rigid: Welded with heavy duty gauge street for extra strength
- Fork Spacing : 2-1/2"
- Legs: 15/64" steel, machine welded, engineered and formed to resist bending.
- Kingpin: 3/4" diameter bolt and nut
- Grease Fittings: Zerk in swivel section
- Axle: 1/2" diameter axle with lock nut

### Applications

- Cargo Containers
- Freight Terminal Trucks
- Material Handling Cart
- Large Platform Truck

### Caster Options

Wheel Diameter	Tread Width	Wheel Type	Swivel Number	Rigid Number	Wheel Bearing	Load Capacity	Overall Height	Swivel Radius
4	2	Pro-Tech Polyurethane	TP7040-01-PRO	TP7040R-01-PRO	Roller	500	5-5/8	3-13/16
		Pro-Tech Xtra	TP7040-01-PRX	TP7040R-01-PRX	Precision	700		
		Polyurethane / Cast Iron	TP7040-01-PCI	TP7040R-01-PCI	Roller	800		
		Plex Solid Polyurethane	TP7040-01-PLX	TP7040R-01-PLX	Roller	700		
		Nylon Glass-Filled	TP7040-01-NGF	TP7040R-01-NGF	Roller	800		
		Phenolic	TP7040-01-PHN	TP7040R-01-PHN	Roller	800		
Steel	TP7040-01-STL	TP7040R-01-STL	Roller	800				
5	2	Pro-Tech Polyurethane	TP7050-01-PRO	TP7050R-01-PRO	Roller	500	6-1/2	4
		Pro-Tech Xtra	TP7050-01-PRX	TP7050R-01-PRX	Precision	800		
		Polyurethane / Cast Iron	TP7050-01-PCI	TP7050R-01-PCI	Roller	1000		
		Plex Solid Polyurethane	TP7050-01-PLX	TP7050R-01-PLX	Roller	800		
		Nylon Glass-Filled	TP7050-01-NGF	TP7050R-01-NGF	Roller	1000		
		Phenolic	TP7050-01-PHN	TP7050R-01-PHN	Roller	1000		
Steel	TP7050-01-STL	TP7050R-01-STL	Roller	1000				
6	2	Pro-Tech Polyurethane	TP7060-01-PRO	TP7060R-01-PRO	Roller	720	7-1/2	4-3/4
		Pro-Tech Xtra	TP7060-01-PRX	TP7060R-01-PRX	Precision	1000		
		Polyurethane / Cast Iron	TP7060-01-PCI	TP7060R-01-PCI	Roller	1200		
		Plex Solid Polyurethane	TP7060-01-PLX	TP7060R-01-PLX	Roller	900		
		Polyurethane / Nylon	TP7060-01-PNY	TP7060R-01-PNY	Roller	1000		
		Nylon Glass-Filled	TP7060-01-NGF	TP7060R-01-NGF	Roller	1200		
Phenolic	TP7060-01-PHN	TP7060R-01-PHN	Roller	1200				
Steel	TP7060-01-STL	TP7060R-01-STL	Roller	1200				
8	2	Pro-Tech Polyurethane	TP7080-01-PRO	TP7080R-01-PRO	Roller	800	10-1/8	6-1/4
		Pro-Tech Xtra	TP7080-01-PRX	TP7080R-01-PRX	Precision	1200		
		Polyurethane / Cast Iron	TP7080-01-PCI	TP7080R-01-PCI	Roller	1200		
		Plex Solid Polyurethane	TP7080-01-PLX	TP7080R-01-PLX	Roller	1000		
		Polyurethane / Nylon	TP7080-01-PNY	TP7080R-01-PNY	Roller	1100		
		Nylon	TP7080-01-NYL	TP7080R-01-NYL	Roller	1400		
		Nylon Glass-Filled	TP7080-01-NGF	TP7080R-01-NGF	Roller	1400		
		Phenolic	TP7080-01-PHN	TP7080R-01-PHN	Roller	1400		
Steel	TP7080-01-STL	TP7080R-01-STL	Roller	1400				

### Fastening

TYPE	CODE	SIZE (Inch)	
Top Plate	01	Overall Size	4-1/2 x 6-1/4
		Bolt Hole Spacing	2-7/16 x 4-15/16 slotted to 3-3/8 x 5-1/4
		Attaching Bolt Size	1/2"

### Options

CODE	DESCRIPTION
WB	Wheel Brake
DW	Double Welded Legs

TP7000 Series

# Heavy Duty Casters

## TP7100 Series / Capacity up to 2200 Lbs.



### Features

- Finish: Bright zinc plating
- Top Plate: 5/32" AISI 1045 drop forged steel for maximum strength
- Swivel: Double ball bearing coined "deep-groove" load and machined component trust raceway
- Rigid: Welded with heavy duty gauge street for extra strength
- Fork Spacing: 3"
- Legs: 23/64" steel, machine welded, engineered and formed to resist bending.
- Kingpin: 3/4" diameter bolt and nut
- Grease Fittings: Zerk in swivel section
- Axle: 3/4" diameter axle with lock nut

### Applications

- Cargo Container
- Freight Terminal Trucks
- Textile Carts & Storage Racks
- Trash Containers
- Heavy Duty Platform Trucks

### Caster Options

- WB: Wheel Brake



- PSL: 4-Position Swivel Lock



Wheel Diameter	Tread Width	Wheel Type	Swivel Number	Rigid Number	Wheel Bearing	Load Capacity	Overall Height	Swivel Radius
4	2-3/4	Polyurethane / Cast Iron	TP7140-01-PCC	TP7140R-01-PCC	Roller	1500	5-5/8	3-7/16
6	2-1/2	Rubber / Cast Iron	TP7160-01-RCI	TP7160R-01-RCI	Roller	700	7-1/2	5-1/4
		Polyurethane / Cast Iron	TP7160-01-PCI	TP7160R-01-PCI	Roller	1600		
		Phenolic	TP7160-01-PHN	TP7160R-01-PHN	Roller	1600		
		Steel	TP7160-01-STL	TP7160R-01-STL	Roller	1600		
8	2-1/2	Rubber / Cast Iron	TP7180-01-RCI	TP7180R-01-RCI	Roller	850	10-1/8	6-1/4
		Polyurethane / Cast Iron	TP7180-01-PCI	TP7180R-01-PCI	Roller	1800		
		Phenolic	TP7180-01-PHN	TP7180R-01-PHN	Roller	1800		
		Steel	TP7180-01-STL	TP7180R-01-STL	Roller	1800		
10	2-1/2	Rubber / Cast Iron	TP7110-01-RCI	TP7110R-01-RCI	Roller	950	11-7/8	7-9/16
		Polyurethane / Cast Iron	TP7110-01-PCI	TP7110R-01-PCI	Roller	2000		
		Phenolic	TP7110-01-PHN	TP7110R-01-PHN	Roller	2000		
		Steel	TP7110-01-STL	TP7110R-01-STL	Roller	2000		
12	2-1/2	Rubber / Cast Iron	TP7112-01-RCI	TP7112R-01-RCI	Roller	1000	13-7/8	8-9/16
		Polyurethane / Cast Iron	TP7112-01-PCI	TP7112R-01-PCI	Roller	2200		
		Phenolic	TP7112-01-PHN	TP7112R-01-PHN	Roller	2200		
		Steel	TP7112-01-STL	TP7112R-01-STL	Roller	2200		

Fastening			
TYPE	CODE	SIZE (Inch)	
Top Plate	01	Overall Size	4-1/2 x 6-1/4
		Bolt Hole Spacing	2-7/16 x 4-15/16 slotted to 3-3/8 x 5-1/4
		Attaching Bolt Size	1/2"

Options	
CODE	DESCRIPTION
WB	Wheel Brake
PSL	4 Position Swivel Lock

TP7100 Series

# Heavy Duty Casters

## TP7200 Series / Capacity up to 2500 Lbs.



### Features

- Finish: Bright zinc plating
- Top Plate: 5/32" AISI 1045 drop forged steel for maximum strength
- Swivel: Double ball bearing coined "deep-groove" load and machined component trust raceway
- Rigid: Welded with heavy duty gauge street for extra strength
- Fork Spacing: 3"
- Legs: 23/64" steel, machine welded, engineered and formed to resist bending.
- Kingpin: 3/4" diameter bolt and nut
- Grease Fittings: Zerk in swivel section
- Axle: 3/4" diameter axle with lock nut

### Applications

- Cargo Container
- Freight Terminal Trucks
- Textile Carts & Storage Racks
- Trash Containers
- Heavy Duty Platform Trucks

### Caster Options

- WB: Wheel Brake
- PSL: 4-Position Swivel Lock



Wheel Diameter	Tread Width	Wheel Type	Swivel Number	Rigid Number	Wheel Bearing	Load Capacity	Overall Height	Swivel Radius
6	2-1/2	Rubber / Cast Iron	TP7260-01-RCI	TP7260R-01-RCI	Roller	700	7-5/8	5-3/16
		Polyurethane / Cast Iron	TP7260-01-PCI	TP7260R-01-PCI	Roller	1600		
		Phenolic	TP7260-01-PHN	TP7260R-01-PHN	Roller	1600		
		Steel	TP7260-01-STL	TP7260R-01-STL	Roller	1600		
8	2-1/2	Rubber / Cast Iron	TP7280-01-RCI	TP7280R-01-RCI	Roller	850	10-1/8	6-3/16
		Polyurethane / Cast Iron	TP7280-01-PCI	TP7280R-01-PCI	Roller	2000		
		Phenolic	TP7280-01-PHN	TP7280R-01-PHN	Roller	2000		
		Steel	TP7280-01-STL	TP7280R-01-STL	Roller	2000		
10	2-1/2	Rubber / Cast Iron	TP7210-01-RCI	TP7210R-01-RCI	Roller	950	11-1/2	7-9/16
		Polyurethane / Cast Iron	TP7210-01-PCI	TP7210R-01-PCI	Roller	2200		
		Phenolic	TP7210-01-PHN	TP7210R-01-PHN	Roller	2200		
		Steel	TP7210-01-STL	TP7210R-01-STL	Roller	2200		
12	2-1/2	Rubber / Cast Iron	TP7212-01-RCI	TP7212R-01-RCI	Roller	1000	13-1/2	8-9/16
		Polyurethane / Cast Iron	TP7212-01-PCI	TP7212R-01-PCI	Roller	2500		
		Phenolic	TP7212-01-PHN	TP7212R-01-PHN	Roller	2500		
		Steel	TP7212-01-STL	TP7212R-01-STL	Roller	2500		

### Fastening

TYPE	CODE	SIZE (Inch)	
Top Plate	01	Overall Size	5-1/4 x 7-1/4
		Bolt Hole Spacing	3-3/8 x 5-1/4 slotted to 4-1/8 x 6-1/8
		Attaching Bolt Size	1/2"

### Options

CODE	DESCRIPTION
WB	Wheel Brake
PSL	4 Position Swivel Lock

TP7200 Series

# Heavy Duty Casters

## TP7500 Series / Capacity up to 3000 Lbs.



### Features

- Finish: Bright zinc plating
- Top Plate: 5/32" AISI 1045 drop forged steel for maximum strength
- Swivel: Double ball bearing coined "deep-groove" load and machined component trust raceway
- Rigid: Welded with heavy duty gauge street for extra strength
- Fork Spacing: 3-1/2"
- Legs: 23/64" steel, machine welded, engineered and formed to resist bending.
- Kingpin: 3/4" diameter bolt and nut
- Grease Fittings: Zerk in swivel section
- Axle: 3/4" diameter axle with lock nut

### Applications

- Cargo Container
- Freight Terminal Trucks
- Textile Carts & Storage Racks
- Trash Containers
- Heavy Duty Platform Trucks

### Caster Options

- WB: Wheel Brake



- PSL: 4-Position Swivel Lock



Wheel Diameter	Tread Width	Wheel Type	Swivel Number	Rigid Number	Wheel Bearing	Load Capacity	Overall Height	Swivel Radius
6	3	Rubber / Cast Iron	TP7560-01-RCI	TP7560R-01-RCI	Roller	750	7-5/8	5-3/16
		Polyurethane / Cast Iron	TP7560-01-PCI	TP7560R-01-PCI	Roller	2000		
		Phenolic	TP7560-01-PHN	TP7560R-01-PHN	Roller	2000		
		Steel	TP7560-01-STL	TP7560R-01-STL	Roller	2000		
8	3	Rubber / Cast Iron	TP7580-01-RCI	TP7580R-01-RCI	Roller	900	10-1/8	6-3/16
		Polyurethane / Cast Iron	TP7580-01-PCI	TP7580R-01-PCI	Roller	2500		
		Phenolic	TP7580-01-PHN	TP7580R-01-PHN	Roller	2500		
		Steel	TP7580-01-STL	TP7580R-01-STL	Roller	2500		
10	3	Rubber / Cast Iron	TP7510-01-RCI	TP7510R-01-RCI	Roller	1200	11-1/2	7-9/16
		Polyurethane / Cast Iron	TP7510-01-PCI	TP7510R-01-PCI	Roller	2700		
		Phenolic	TP7510-01-PHN	TP7510R-01-PHN	Roller	2700		
		Steel	TP7510-01-STL	TP7510R-01-STL	Roller	2700		
12	3	Rubber / Cast Iron	TP7512-01-RCI	TP7512R-01-RCI	Roller	1500	13-1/2	8-9/16
		Polyurethane / Cast Iron	TP7512-01-PCI	TP7512R-01-PCI	Roller	3000		
		Phenolic	TP7512-01-PHN	TP7512R-01-PHN	Roller	3000		
		Steel	TP7512-01-STL	TP7512R-01-STL	Roller	3000		

Fastening			
TYPE	CODE	SIZE (Inch)	
Top Plate	01	Overall Size	5-1/4 x 7-1/4
		Bolt Hole Spacing	3-3/8 x 5-1/4 slotted to 4-1/8 x 6-1/8
		Attaching Bolt Size	1/2"

Options	
CODE	DESCRIPTION
WB	Wheel Brake
PSL	4 Position Swivel Lock

TP7500 Series

# Super Heavy Duty Casters

## TP7600 Series / Capacity up to 4400 Lbs.



### Features

- Finish: Bright zinc plating
- Swivel: Precision sealed ball bearing eliminates need for routine maintenance (Thrust Bearing #51117 & Taper Roller Bearing # 30206)
- Rigid: Welded with heavy duty gauge steel for extra strength
- Top Plate: 1/2" steel plate
- Fork Spacing : 3-1/4"
- Legs: 3/8" steel, machine welded, engineered and formed to resist bending.
- Kingpin: 1" diameter bolt and nut
- Axle: 3/4" diameter axle with lock nut

### Applications

- Cargo Container
- Freight Terminal Trucks
- Textile Carts & Storage Racks
- Trash Containers
- Heavy Duty Platform Trucks

### Caster Options

Wheel Diameter	Tread Width	Wheel Type	Swivel Number	Rigid Number	Wheel Bearing	Load Capacity	Overall Height	Swivel Radius
6	2-1/2	Polyurethane / Aluminum	TP7660-01-PAL	TP7660R-01-PAL	Precision Ball	3300	8-7/8	4-13/16
8	2-1/2	Polyurethane / Aluminum	TP7680-01-PAL	TP7680R-01-PAL	Precision Ball	4400	10-13/16	6-1/4

### Fastening

TYPE	CODE	SIZE (Inch)
Top Plate	01	Overall Size 6-7/8 x 5-1/2
		Bolt Hole Spacing 5-13/16 x 4-3/8 slotted to 5-3/16 x 3-7/8
		Attaching Bolt Size 1/2"

TP7600 Series



# Med / Heavy Kingpinless Casters

## TP6600 KPL Series / Capacity up to 1250 Lbs.



### Features

- Finish: Bright zinc plating
- Top Plate: 1/4" steel plate
- Swivel: One row of 3/8" ball bearing mounted in a heat treated precision machined raceway
- Fork Spacing: 2-1/2"
- Grease Fittings: Zerk in swivel section
- PSL-Notched: All swivel rigs notched for optional 4-Position
- Axle: 1/2" diameter axle with lock nut

### Applications

- Material Handling
- Mobile Storage Racks
- Mobile Tool Chests
- Platform Carts
- Warehouse Trucks

### Caster Options

- TLB: Top Lock Brake



- PSL-4 (Attach Type)



Fastening			
TYPE	CODE	SIZE (Inch)	
Top Plate	01KPL	Overall Size	4 x 4-1/2
		Bolt Hole Spacing	2-5/8 x 3-5/8 slotted to 3 x 3
		Attaching Bolt Size	3/8
	04KPL	Overall Size	5 x 5-1/2
		Bolt Hole Spacing	4-1/8 x 4-1/2
		Attaching Bolt Size	3/8"
	07KPL	Overall Size	4-1/2 x 6-1/4
		Bolt Hole Spacing	2-7/16 x 4-15/16 slotted to 3-3/8 x 5-1/4
		Attaching Bolt Size	1/2"

Options	
CODE	DESCRIPTION
TLB	Top Lock Brake
FLB	Front Lock Brake
CLB	Cam Lock Brake
PSL	4 Position Swivel Lock

TP6600 KPL Series

# Med / Heavy Kingpinless Casters

## TP6600 KPL Series / Capacity up to 1250 Lbs.

Wheel Diameter	Tread Width	Wheel Type	Swivel Number	Rigid Number	Wheel Bearing	Load Capacity	Overall Height	Swivel Radius
4	2	Mirage (TPR)	TP6640-KPL-MIR	TP6640R-KPL-MIR	Roller	350	5-5/8	3-9/16
		Crown Mirage (TPR)	TP6640-KPL-MRC	TP6640R-KPL-MRC	Roller	350		
		Rubber / Cast Iron	TP6640-KPL-RCI	TP6640R-KPL-RCI	Roller	400		
		Rubber / Nylon	TP6640-KPL-RNY	TP6640R-KPL-RNY	Roller	400		
		Pro-Tech Polyurethane	TP6640-KPL-PRO	TP6640R-KPL-PRO	Roller	500		
		Pro-Tech Xtra	TP6640-KPL-PRX	TP6640R-KPL-PRX	Precision	700		
		Polyurethane / Cast Iron	TP6640-KPL-PCI	TP6640R-KPL-PCI	Roller	800		
		Plex Solid Polyurethane	TP6640-KPL-PLX	TP6640R-KPL-PLX	Roller	700		
		Nylon Glass-Filled	TP6640-KPL-NGF	TP6640R-KPL-NGF	Roller	800		
		Phenolic	TP6640-KPL-PHN	TP6640R-KPL-PHN	Roller	800		
		Hi-Temp Phenolic	TP6640-KPL-PHN-HT	TP6640R-KPL-PHN-HT	Roller	800		
		Steel	TP6640-KPL-STL	TP6640R-KPL-STL	Roller	800		
		V-Groove Steel	TP6640-KPL-VGR	TP6640R-KPL-VGR	Roller	700		
5	2	Mirage (TPR)	TP6650-KPL-MIR	TP6650R-KPL-MIR	Roller	400	6-1/2	4-1/4
		Crown Mirage (TPR)	TP6650-KPL-MRC	TP6650R-KPL-MRC	Roller	400		
		Rubber / Cast Iron	TP6650-KPL-RCI	TP6650R-KPL-RCI	Roller	450		
		Rubber / Nylon	TP6650-KPL-RNY	TP6650R-KPL-RNY	Roller	450		
		Pro-Tech Polyurethane	TP6650-KPL-PRO	TP6650R-KPL-PRO	Roller	600		
		Pro-Tech Xtra	TP6650-KPL-PRX	TP6650R-KPL-PRX	Precision	800		
		Polyurethane / Cast Iron	TP6650-KPL-PCI	TP6650R-KPL-PCI	Roller	1000		
		Plex Solid Polyurethane	TP6650-KPL-PLX	TP6650R-KPL-PLX	Roller	800		
		Polyurethane / Nylon	TP6650-KPL-PNY	TP6650R-KPL-PNY	Roller	1000		
		Nylon Glass-Filled	TP6650-KPL-NGF	TP6650R-KPL-NGF	Roller	1000		
		Heavy Duty Plastic	TP6650-KPL-HPR	TP6650R-KPL-HPR	Roller	550		
		Phenolic	TP6650-KPL-PHN	TP6650R-KPL-PHN	Roller	1000		
		Fever Hi-Temp	TP6650-KPL-FVR	TP6650R-KPL-FVR	Roller	1000		
Steel	TP6650-KPL-STL	TP6650R-KPL-STL	Roller	1000				
6	2	Mirage (TPR)	TP6660-KPL-MIR	TP6660R-KPL-MIR	Roller	500	7-1/2	4-1/2
		Crown Mirage (TPR)	TP6660-KPL-MRC	TP6660R-KPL-MRC	Roller	500		
		Rubber / Cast Iron	TP6660-KPL-RCI	TP6660R-KPL-RCI	Roller	550		
		Rubber / Aluminum	TP6660-KPL-RAL	TP6660R-KPL-RAL	Roller	450		
		Rubber / Nylon	TP6660-KPL-RNY	TP6660R-KPL-RNY	Roller	550		
		Pro-Tech Polyurethane	TP6660-KPL-PRO	TP6660R-KPL-PRO	Roller	720		
		Pro-Tech Xtra	TP6660-KPL-PRX	TP6660R-KPL-PRX	Precision	1000		
		Polyurethane / Cast Iron	TP6660-KPL-PCI	TP6660R-KPL-PCI	Roller	1200		
		Plex Solid Polyurethane	TP6660-KPL-PLX	TP6660R-KPL-PLX	Roller	900		
		Polyurethane / Nylon	TP6660-KPL-PNY	TP6660R-KPL-PNY	Roller	1200		
		Nylon Glass-Filled	TP6660-KPL-NGF	TP6660R-KPL-NGF	Roller	1200		
		Heavy Duty Plastic	TP6660-KPL-HPR	TP6660R-KPL-HPR	Roller	650		
		Phenolic	TP6660-KPL-PHN	TP6660R-KPL-PHN	Roller	1200		
Fever Hi-Temp	TP6660-KPL-FVR	TP6660R-KPL-FVR	Roller	1200				
Steel	TP6660-KPL-STL	TP6660R-KPL-STL	Roller	1200				
8	2	Mirage (TPR)	TP6680-KPL-MIR	TP6680R-KPL-MIR	Roller	600	9-1/2	6-1/2
		Crown Mirage (TPR)	TP6680-KPL-MRC	TP6680R-KPL-MRC	Roller	600		
		Rubber / Cast Iron	TP6680-KPL-RCI	TP6680R-KPL-RCI	Roller	600		
		Rubber / Nylon	TP6680-KPL-RNY	TP6680R-KPL-RNY	Roller	600		
		Pro-Tech Polyurethane	TP6680-KPL-PRO	TP6680R-KPL-PRO	Roller	800		
		Pro-Tech Xtra	TP6680-KPL-PRX	TP6680R-KPL-PRX	Precision	1200		
		Polyurethane / Cast Iron	TP6680-KPL-PCI	TP6680R-KPL-PCI	Roller	1250		
		Plex Solid Polyurethane	TP6680-KPL-PLX	TP6680R-KPL-PLX	Roller	1000		
		Polyurethane / Nylon	TP6680-KPL-PNY	TP6680R-KPL-PNY	Roller	1250		
		Nylon	TP6680-KPL-NYL	TP6680R-KPL-NYL	Roller	1000		
		Nylon Glass-Filled	TP6680-KPL-NGF	TP6680R-KPL-NGF	Roller	1250		
		Phenolic	TP6680-KPL-PHN	TP6680R-KPL-PHN	Roller	1250		
		Fever Hi-Temp	TP6680-KPL-FVR	TP6680R-KPL-FVR	Roller	1250		
Steel	TP6680-KPL-STL	TP6680R-KPL-STL	Roller	1250				

TP6600 KPL Series

# Med / Heavy Kingpinless Casters

## TP6800 KPL Series / Capacity up to 1400 Lbs.



### Features

- Finish :Bright zinc plating
- Top Plate: 1/4" Steel plate
- Swivel: One row of 3/8" ball bearing mounted in a heat treated precision machined raceway
- Fork Spacing: 2-1/2"
- Grease Fittings: Zerk in swivel section
- PSL-Notched: All swivel rigs notched for optional 4-Position
- Axle: 1/2" diameter axle with lock nut

### Applications

- Military Equipment
- Air Cargo & Ground Support
- Tow Line & Shock Load Applications
- Platform Trucks & Freight Terminal Dollies

### Caster Options

- TLB: Top Lock Brake



### Fastening

TYPE	CODE	SIZE (Inch)	
Top Plate	KPL	Overall Size	4-1/2 x 6-1/4
		Bolt Hole Spacing	2-7/16 x 4-15/16 slotted to 3-3/8 x 5-1/4
		Attaching Bolt Size	1/2"

### Options

CODE	DESCRIPTION
TLB	Top Lock Brake
DW	Double Welded Legs

# Med / Heavy Kingpinless Casters

## TP6800 KPL Series / Capacity up to 1400 Lbs.

Wheel Diameter	Tread Width	Wheel Type	Swivel Number	Rigid Number	Wheel Bearing	Load Capacity	Overall Height	Swivel Radius
4	2	Mirage (TPR)	TP6840-KPL-MIR	TP6840R-KPL-MIR	Roller	350	6-1/16	3-13/16
		Crown Mirage (TPR)	TP6840-KPL-MRC	TP6840R-KPL-MRC	Roller	350		
		Rubber / Cast Iron	TP6840-KPL-RCI	TP6840R-KPL-RCI	Roller	400		
		Rubber / Nylon	TP6840-KPL-RNY	TP6840R-KPL-RNY	Roller	400		
		Pro-Tech Polyurethane	TP6840-KPL-PRO	TP6840R-KPL-PRO	Roller	500		
		Pro-Tech Xtra	TP6840-KPL-PRX	TP6840R-KPL-PRX	Precision	700		
		Polyurethane / Cast Iron	TP6840-KPL-PCI	TP6840R-KPL-PCI	Roller	800		
		Plex Solid Polyurethane	TP6840-KPL-PLX	TP6840R-KPL-PLX	Roller	700		
		Polyurethane / Nylon	TP6840-KPL-PNY	TP6840R-KPL-PNY	Roller	700		
		Nylon Glass-Filled	TP6840-KPL-NGF	TP6840R-KPL-NGF	Roller	800		
		Phenolic	TP6840-KPL-PHN	TP6840R-KPL-PHN	Roller	800		
Hi-Temp Phenolic	TP6840-KPL-PHN-HT	TP6840R-KPL-PHN-HT	Roller	800				
Steel	TP6840-KPL-STL	TP6840R-KPL-STL	Roller	700				
5	2	Mirage (TPR)	TP6850-KPL-MIR	TP6850R-KPL-MIR	Roller	400	7	4
		Crown Mirage (TPR)	TP6850-KPL-MRC	TP6850R-KPL-MRC	Roller	400		
		Rubber / Cast Iron	TP6850-KPL-RCI	TP6850R-KPL-RCI	Roller	450		
		Rubber / Nylon	TP6850-KPL-RNY	TP6850R-KPL-RNY	Roller	450		
		Pro-Tech Polyurethane	TP6850-KPL-PRO	TP6850R-KPL-PRO	Roller	600		
		Pro-Tech Xtra	TP6850-KPL-PRX	TP6850R-KPL-PRX	Precision	800		
		Polyurethane / Cast Iron	TP6850-KPL-PCI	TP6850R-KPL-PCI	Roller	1000		
		Plex Solid Polyurethane	TP6850-KPL-PLX	TP6850R-KPL-PLX	Roller	800		
		Polyurethane / Nylon	TP6850-KPL-PNY	TP6850R-KPL-PNY	Roller	1000		
		Nylon Glass-Filled	TP6850-KPL-NGF	TP6850R-KPL-NGF	Roller	800		
		Phenolic	TP6850-KPL-PHN	TP6850R-KPL-PHN	Roller	1000		
Steel	TP6850-KPL-STL	TP6850R-KPL-STL	Roller	800				
6	2	Mirage (TPR)	TP6860-KPL-MIR	TP6860R-KPL-MIR	Roller	500	8	4-3/4
		Crown Mirage (TPR)	TP6860-KPL-MRC	TP6860R-KPL-MRC	Roller	500		
		Rubber / Cast Iron	TP6860-KPL-RCI	TP6860R-KPL-RCI	Roller	550		
		Rubber / Nylon	TP6860-KPL-RNY	TP6860R-KPL-RNY	Roller	550		
		Pro-Tech Polyurethane	TP6860-KPL-PRO	TP6860R-KPL-PRO	Roller	720		
		Pro-Tech Xtra	TP6860-KPL-PRX	TP6860R-KPL-PRX	Precision	1000		
		Polyurethane / Cast Iron	TP6860-KPL-PCI	TP6860R-KPL-PCI	Roller	1200		
		Plex Solid Polyurethane	TP6860-KPL-PLX	TP6860R-KPL-PLX	Roller	900		
		Polyurethane / Nylon	TP6860-KPL-PNY	TP6860R-KPL-PNY	Roller	1200		
		Nylon Glass-Filled	TP6860-KPL-NGF	TP6860R-KPL-NGF	Roller	1000		
		Phenolic	TP6860-KPL-PHN	TP6860R-KPL-PHN	Roller	1200		
Steel	TP6860-KPL-STL	TP6860R-KPL-STL	Roller	1200				
8	2	Mirage (TPR)	TP6880-KPL-MIR	TP6880R-KPL-MIR	Roller	600	10-1/4	6-1/4
		Crown Mirage (TPR)	TP6880-KPL-MRC	TP6880R-KPL-MRC	Roller	600		
		Rubber / Cast Iron	TP6880-KPL-RCI	TP6880R-KPL-RCI	Roller	600		
		Rubber / Nylon	TP6880-KPL-RNY	TP6880R-KPL-RNY	Roller	600		
		Pro-Tech Polyurethane	TP6880-KPL-PRO	TP6880R-KPL-PRO	Roller	800		
		Pro-Tech Xtra	TP6880-KPL-PRX	TP6880R-KPL-PRX	Precision	1200		
		Polyurethane / Cast Iron	TP6880-KPL-PCI	TP6880R-KPL-PCI	Roller	1400		
		Plex Solid Polyurethane	TP6880-KPL-PLX	TP6880R-KPL-PLX	Roller	1000		
		Polyurethane / Nylon	TP6880-KPL-PNY	TP6880R-KPL-PNY	Roller	1400		
		Nylon Glass-Filled	TP6880-KPL-NGF	TP6880R-KPL-NGF	Roller	1200		
		Phenolic	TP6880-KPL-PHN	TP6880R-KPL-PHN	Roller	1400		
Steel	TP6880-KPL-STL	TP6880R-KPL-STL	Roller	1400				

TP6800 KPL Series

# Heavy Duty Kingpinless Casters

## TP7200 KPL Series / Capacity up to 2500 Lbs.



### Features

- Finish: Bright zinc plating
- Top Plate: 23/64" Steel plate
- Swivel: One row of 1/2" ball bearing mounted in a heat treated precision machined raceway
- Fork Spacing: 3"
- Leg Thickness: 23/64" steel plate
- Grease Fittings: Zerk in swivel section
- PSL-Notched: All swivel rigs notched for optional 4-Position
- Axle: 3/4" diameter axle with lock nut

### Applications

- Military Equipment
- Air Cargo & Ground Support
- Tow Line & Shock Load Applications
- Platform Trucks & Freight Terminal Dollies

### Caster Options

- WB: Wheel Brake
- PSL: 4-Position Swivel Lock Support



Wheel Diameter	Tread Width	Wheel Type	Swivel Number	Rigid Number	Wheel Bearing	Load Capacity	Overall Height	Swivel Radius
6	2-1/2	Rubber / Cast Iron	TP7260-KPL-RCI	TP7260R-KPL-RCI	Roller	700	7-11/16	5-3/16
		Polyurethane / Cast Iron	TP7260-KPL-PCI	TP7260R-KPL-PCI	Roller	1600		
		Phenolic	TP7260-KPL-PHN	TP7260R-KPL-PHN	Roller	1600		
		Steel	TP7260-KPL-STL	TP7260R-KPL-STL	Roller	1600		
8	2-1/2	Rubber / Cast Iron	TP7280-KPL-RCI	TP7280R-KPL-RCI	Roller	850	10-5/16	6-3/16
		Polyurethane / Cast Iron	TP7280-KPL-PCI	TP7280R-KPL-PCI	Roller	2000		
		Phenolic	TP7280-KPL-PHN	TP7280R-KPL-PHN	Roller	2000		
		Steel	TP7280-KPL-STL	TP7280R-KPL-STL	Roller	2000		
10	2-1/2	Rubber / Cast Iron	TP7210-KPL-RCI	TP7210R-KPL-RCI	Roller	950	12-1/16	7-9/16
		Polyurethane / Cast Iron	TP7210-KPL-PCI	TP7210R-KPL-PCI	Roller	2200		
		Phenolic	TP7210-KPL-PHN	TP7210R-KPL-PHN	Roller	2200		
		Steel	TP7210-KPL-STL	TP7210R-KPL-STL	Roller	2200		
12	2-1/2	Rubber / Cast Iron	TP7212-KPL-RCI	TP7212R-KPL-RCI	Roller	1000	14-1/16	8-9/16
		Polyurethane / Cast Iron	TP7212-KPL-PCI	TP7212R-KPL-PCI	Roller	2500		
		Phenolic	TP7212-KPL-PHN	TP7212R-KPL-PHN	Roller	2500		
		Steel	TP7212-KPL-STL	TP7212R-KPL-STL	Roller	2500		

Fastening			
TYPE	CODE	SIZE (Inch)	
Top Plate	KPL	Overall Size	5-1/4 x 7-1/4
		Bolt Hole Spacing	3-3/8 x 5-1/4 slotted to 4-1/8 x 6-1/8
		Attaching Bolt Size	1/2"

Options	
CODE	DESCRIPTION
WB	Wheel Brake
PSL	4 Position Swivel Lock

TP7200 KPL Series

# Heavy Duty Kingpinless Casters

## TP7500 KPL Series / Capacity up to 3000 Lbs.



### Features

- Finish: Bright zinc plating
- Top Plate: 23/64" Steel plate
- Swivel: One row of 1/2" ball bearing mounted in a heat treated precision machined raceway
- Fork Spacing: 3-1/2"
- Leg Thickness: 23/64" steel plate
- Grease Fittings: Zerk in swivel section
- PSL-Notched: All swivel rigs notched for optional 4-Position
- Axle: 3/4" diameter axle with lock nut

### Applications

- Military Equipment
- Air Cargo & Ground Support
- Tow Line & Shock Load Applications
- Platform Trucks & Freight Terminal Dollies

### Caster Options

- WB: Wheel Brake
- PSL: 4-Position Swivel Lock



Wheel Diameter	Tread Width	Wheel Type	Swivel Number	Rigid Number	Wheel Bearing	Load Capacity	Overall Height	Swivel Radius
6	3	Rubber / Cast Iron	TP7560-KPL-RCI	TP7560R-KPL-RCI	Roller	750	7-11/16	5-3/16
		Polyurethane / Cast Iron	TP7560-KPL-PCI	TP7560R-KPL-PCI	Roller	2000		
		Phenolic	TP7560-KPL-PHN	TP7560R-KPL-PHN	Roller	2000		
		Steel	TP7560-KPL-STL	TP7560R-KPL-STL	Roller	2000		
8	3	Rubber / Cast Iron	TP7580-KPL-RCI	TP7580R-KPL-RCI	Roller	900	10-5/16	6-3/16
		Polyurethane / Cast Iron	TP7580-KPL-PCI	TP7580R-KPL-PCI	Roller	2500		
		Phenolic	TP7580-KPL-PHN	TP7580R-KPL-PHN	Roller	2500		
		Steel	TP7580-KPL-STL	TP7580R-KPL-STL	Roller	2500		
10	3	Rubber / Cast Iron	TP7510-KPL-RCI	TP7510R-KPL-RCI	Roller	1200	12-1/16	7-9/16
		Polyurethane / Cast Iron	TP7510-KPL-PCI	TP7510R-KPL-PCI	Roller	2700		
		Phenolic	TP7510-KPL-PHN	TP7510R-KPL-PHN	Roller	2700		
		Steel	TP7510-KPL-STL	TP7510R-KPL-STL	Roller	2700		
12	3	Rubber / Cast Iron	TP7512-KPL-RCI	TP7512R-KPL-RCI	Roller	1500	14-1/16	8-9/16
		Polyurethane / Cast Iron	TP7512-KPL-PCI	TP7512R-KPL-PCI	Roller	3000		
		Phenolic	TP7512-KPL-PHN	TP7512R-KPL-PHN	Roller	3000		
		Steel	TP7512-KPL-STL	TP7512R-KPL-STL	Roller	3000		

### Fastening

TYPE	CODE	SIZE (Inch)	
Top Plate	KPL	Overall Size	5-1/4 x 7-1/4
		Bolt Hole Spacing	3-3/8 x 5-1/4 slotted to 4-1/8 x 6-1/8
		Attaching Bolt Size	1/2"

### Options

CODE	DESCRIPTION
WB	Wheel Brake
PSL	4 Position Swivel Lock

TP7500 KPL Series

# Auto Ind. / Maintenance Free Casters

## TP6601MF Series / Capacity up to 1300 Lbs.

TP6601MF Series



### Features

- Ergonomic Designed for easy swiveling and noise reduction
- Finish: Bright zinc plating
- Top Plate: 1/4" steel plate
- Swivel: Precision sealed ball bearing #6007
- Fork Spacing: 2-1/2"
- Leg Thickness: 1/4" steel plate
- Axle: 1/2" diameter axle with lock nut

### Applications

- Auto Pallets
- Military Equipment
- Tractor Pulled Trailers
- Air Cargo & Ground Support
- Tow Line & Shock Load Applications
- Platform Trucks & Freight Terminal Dollies

### Caster Options

- Sealed Precision Raceway



Wheel Diameter	Tread Width	Wheel Type	Swivel Number	Rigid Number	Wheel Bearing	Load Capacity	Overall Height
6	2	Polyurethane	TP6661MF-01-PCIS-PBB	TP6661RMF-01-PCIS-PBB	Precision	1200	7-1/2
8	2	Polyurethane	TP6681MF-01-PCIS-PBB	TP6681RMF-01-PCIS-PBB	Precision	1300	10-1/8

\* Swivel Raceway : Precision #6007ZZ / Polyurethan Wheel : #6203-2RS

Fastening			
TYPE	CODE	SIZE (Inch)	
Top Plate	01	Overall Size	4 x 4-1/2
		Bolt Hole Spacing	3-5/8 x 3-5/8 slotted to 3 x 3
		Attaching Bolt Size	3/8
	05	Overall Size	4-1/2 x 5
		Bolt Hole Spacing	3 x 4
		Attaching Bolt Size	3/8
	07	Overall Size	4-1/2 x 6-1/4
		Bolt Hole Spacing	2-7/16 x 4-15/16 slotted to 3-3/8 x 5-1/4
		Attaching Bolt Size	1/2

# Auto Ind. / Maintenance Free Casters

## TP7002 MF Series / Capacity up to 1500 Lbs.



### Features

- Ergonomic Designed for easy swiveling and noise reduction
- Finish: Bright zinc plating
- Top Plate: 23/64" steel plate
- Swivel: Precision sealed ball bearing #6210-2RS
- Fork Spacing: 2-1/2"
- Leg Thickness: 1/4" steel plate
- Axle: 1/2" diameter axle with lock nut

### Applications

- Auto Pallets
- Military Equipment
- Tractor Pulled Trailers
- Air Cargo & Ground Support
- Tow Line & Shock Load Applications
- Platform Trucks & Freight Terminal Dollies

### Caster Options

Wheel Diameter	Tread Width	Wheel Type	Swivel Number	Rigid Number	Wheel Bearing	Load Capacity	Overall Height
6	2	Polyurethane	TP7062MF-01-PCIS-PBB	TP7062RMF-01-PCIS-PBB	Precision	1200	8.07
8	2	Polyurethane	TP7082MF-01-PCIS-PBB	TP7082RMF-01-PCIS-PBB	Precision	1500	10-1/8

\* Swivel Raceway : Precision #6210-2RS / Polyurethan Wheel : #6203-2RS

### Fastening

TYPE	CODE	SIZE (Inch)	
Top Plate	01	Overall Size	4 x 4-1/2
		Bolt Hole Spacing	3-5/8 x 3-5/8 slotted to 3 x 3
		Attaching Bolt Size	3/8
	05	Overall Size	4-1/2 x 5
		Bolt Hole Spacing	3 x 4
		Attaching Bolt Size	3/8
	07	Overall Size	4-1/2 x 6-1/4
		Bolt Hole Spacing	2-7/16 x 4-15/16 slotted to 3-3/8 x 5-1/4
		Attaching Bolt Size	1/2



# Shock Absorbing Casters

## TP9600 SA Series / Capacity up to 1200 Lbs.

TP9660 SA Series



### Features

- Finish: Bright zinc plating
- Top Plate: 15/64" steel plate
- Swivel: Double ball bearing with hardened raceways for extra strength
- Fork Spacing: 2-17/64" (2.265")
- Leg Thickness: 15/64" steel plate
- Axle: 1/2" diameter axle with lock nut
- Overall Height: Off loading: 8-1/16", On loading : 7-7/16"

### Applications

- Auto Pallets
- Military Equipment
- Tractor Pulled Trailers
- Air Cargo & Ground Support
- Tow Line & Shock Load Applications
- Platform Trucks & Freight Terminal Dollies

### Caster Options

Wheel Diameter	Tread Width	Wheel Type	Swivel Number	Rigid Number	Wheel Bearing	Load Capacity	Overall Height	Swivel Radius
6	2	Polyurethane / Cast Iron	<b>TP9660-SA-PCC</b>	<b>TP9660R-SA-PCC</b>	Roller	800	8-1/16	5
		Polyurethane / Cast Iron	<b>TP9660-SA-PCC-PBB</b>	<b>TP9660R-SA-PCC-PBB</b>	Precision Ball			
8	2	Polyurethane / Cast Iron	<b>TP9680-SA-PCC</b>	<b>TP9680R-SA-PCC</b>	Roller	1200	9-3/4	6-1/2
		Polyurethane / Cast Iron	<b>TP9680-SA-PCC-PBB</b>	<b>TP9680R-SA-PCC-PBB</b>	Precision Ball			

Fastening			
TYPE	CODE	SIZE (Inch)	
Top Plate	SA	Overall Size	4-1/2 x 6-1/4
		Bolt Hole Spacing	2-7/16 x 4-15/16 slotted to 3-3/8 x 5-1/4
		Attaching Bolt Size	1/2"

Options	
CODE	DESCRIPTION
<b>Red</b>	Spring Active up to 800 lbs

TP5100 Series

# Stainless Steel Casters

## TP5100 Series / Capacity up to 300 Lbs.



### Features

- Top Plate: 5/32" 304 Stainless steel plate
- Swivel: Stainless steel double ball bearing racewa
- Kingpin: 1/2" Stainless steel
- Legs: 304 Stainless steel plate
- Axle: 3/8" diameter stainless steel axle with lock nut

### Applications

- Food Service & Restaurants Carts
- Washdown Applications
- Hospitals and Institutions

### Caster Options

- TLB: Top Lock Brake



Wheel Diameter	Tread Width	Wheel Type	Swivel Number	Rigid Number	Wheel Bearing	Load Capacity	Overall Height	Swivel Radius
3	1-1/4	Mirage (TPR)	TP5130-**-MIR-PB	TP5130R-**-MIR-PB	Plain	200	4	2-7/8
		Light Duty Plastic	TP5130-**-LDP	TP5130R-**-LDP	Plain	210		
	1-3/8	Heavy Duty Plastic	TP5130-**-HDP	TP5130R-**-HDP	Plain	300		
		1-1/4	Polyurethane	TP5130-**-PLY-PB	TP5130R-**-PLY-PB	Plain		
		Solid Polyurethane	TP5130-**-PLX	TP5130R-**-PLX	Precision	300		
4	1-1/4	Mirage (TPR)	TP5140-**-MIR-PB	TP5140R-**-MIR-PB	Plain	250	5	3-1/4
		Polyurethane	TP5140-**-PLY-PB	TP5140R-**-PLY-PB	Plain	230		
		Solid Polyurethane	TP5140-**-PLX	TP5140R-**-PLX	Precision	300		
	1-15/32	Light Duty Plastic	TP5140-**-LDP	TP5140R-**-LDP	Plain	250		
		Heavy Duty Plastic	TP5140-**-HDP	TP5140R-**-HDP	Plain	300		
	1-1/2	Phenolic	TP5140-**-PHN	TP5140R-**-PHN	Roller	300		
			TP5140-**-PHN-PB	TP5140R-**-PHN-PB	Plain	300		
		Phenolic Hi-Temp	TP5140-**-PHN-HT	TP5140R-**-PHN-HT	Roller	300		
			TP5140-**-PHN-HT-PB	TP5140R-**-PHN-HT-PB	Plain	300		
		Fever Nylon Hi-Temp	TP5140-**-FVR	TP5140R-**-FVR	Roller	300		
		Fever Nylon Hi-Temp	TP5140-**-FVR-PB	TP5140R-**-FVR-PB	Plain	300		
		Fever-Tech Hi-Temp	TP5140-**-FVT	TP5140R-**-FVT	Roller	300		
5	1-1/4	Mirage (TPR)	TP5150-**-MIR-PB	TP5150R-**-MIR-PB	Plain	250	6	4
		Polyurethane	TP5150-**-PLY-PB	TP5150R-**-PLY-PB	Plain	250		
		Solid Polyurethane	TP5150-**-PLX	TP5150R-**-PLX	Precision	325		
	1-15/32	Heavy Duty Plastic	TP5150-**-HDP	TP5150R-**-HDP	Plain	300		
		Phenolic	TP5150-**-PHN	TP5150R-**-PHN	Roller	325		
	TP5150-**-PHN-PB		TP5150R-**-PHN-PB	Plain	325			
	1-1/2	Phenolic Hi-Temp	TP5150-**-PHN-HT	TP5150R-**-PHN-HT	Roller	325		
			TP5150-**-PHN-HT-PB	TP5150R-**-PHN-HT-PB	Plain	325		
		Fever Nylon Hi-Temp	TP5150-**-FVR	TP5150R-**-FVR	Roller	325		
		Fever Nylon Hi-Temp	TP5150-**-FVR-PB	TP5150R-**-FVR-PB	Plain	325		

### Fastening

TYPE	CODE	SIZE (Inch)	
Top Plate	01	Overall Size	2-3/8 x 3-5/8
		Bolt Hole Spacing	1-3/4 x 2-3/4 slotted to 3
		Attaching Bolt Size	5/16
	03	Overall Size	3-3/4 x 4-1/2
Bolt Hole Spacing		2-5/8 x 3-5/8 slotted to 3 x 3	
Attaching Bolt Size		5/16	
Grip Ring Stem	11	7/16 x 1-1/2	
	12	0.845 x 2-3/16	
Threaded Stem	21	1/2 - 13 x 1	
	22	1/2 - 13 x 1-1/2	
	23	1/2 - 13 x 2	
	24	1/2 - 13 x 2-1/2	
	25	1/2 - 13 x 2-3/4 (fully threaded)	
	26	1/2 - 13 x 2-3/4 (threaded 1-1/2" from top)	

### Options

CODE	DESCRIPTION
TLB	Top Lock Brake

Add Option Code to end of part number.

# Med / Heavy Duty Stainless Steel Casters

## TP6700 Series / Capacity up to 1250 Lbs.

TP6700 Series



### Features

- Top Plate: 7/32" 304 Stainless steel plate
- Swivel: Stainless steel double ball bearing raceway
- Kingpin: 5/8" Stainless steel
- Legs: 304 Stainless steel plate
- Grease Fittings: Zerk in swivel section
- Axle: 1/2" diameter stainless steel axle with lock nut

### Applications

- Food Service Carts
- Restaurants Equipment
- Washdown Applications
- Wet or Corrosive Conditions

### Caster Options

- TLB: Top Lock Brake



Fastening			
TYPE	CODE	SIZE (Inch)	
Top Plate	01	Overall Size	4 x 4-1/2
		Bolt Hole Spacing	2-5/8 x 3-5/8 slotted to 3 x 3
		Attaching Bolt Size	3/8

Options	
CODE	DESCRIPTION
TLB	Top Lock Brake
FLB	Front Lock Brake
PSL	4 Position Swivel Lock
DW	Double Welded Legs
SL	Sealed Swivel

# Med / Heavy Duty Stainless Steel Casters

## TP6700 Series / Capacity up to 1250 Lbs.

Wheel Diameter	Tread Width	Wheel Type	Swivel Number	Rigid Number	Wheel Bearing	Load Capacity	Overall Height	Swivel Radius
4	2	Mirage (TPR)	TP6740-01-MIR	TP6740R-01-MIR	Roller	350	5-5/8	3-9/16
		Mirage (TPR)	TP6740-01-MIR-DB	TP6740R-01-MIR-DB	Delrin	350		
		Crown Mirage (TPR)	TP6740-01-MRC	TP6740R-01-MRC	Roller	350		
		Crown Mirage (TPR)	TP6740-01-MRC-DB	TP6740R-01-MRC-DB	Delrin	350		
		Pro-Tech Polyurethane	TP6740-01-PRO	TP6740R-01-PRO	Roller	500		
		Pro-Tech Polyurethane	TP6740-01-PRO-DB	TP6740R-01-PRO-DB	Delrin	500		
		Plex Solid Polyurethane	TP6740-01-PLX	TP6740R-01-PLX	Roller	700		
		Plex Solid Polyurethane	TP6740-01-PLX-DB	TP6740R-01-PLX-DB	Delrin	700		
		Nylon Glass-Filled	TP6740-01-NGF	TP6740R-01-NGF	Roller	800		
		Nylon Glass-Filled	TP6740-01-NGF-DB	TP6740R-01-NGF-DB	Delrin	800		
		Heavy Duty Plastic	TP6740-01-HDP	TP6740R-01-HDP	Roller	450		
		Phenolic	TP6740-01-PHN	TP6740R-01-PHN	Roller	800		
		Phenolic	TP6740-01-PHN-DB	TP6740R-01-PHN-DB	Delrin	800		
5	2	Mirage (TPR)	TP6750-01-MIR	TP6750R-01-MIR	Roller	400	6-1/2	4-1/4
		Mirage (TPR)	TP6750-01-MIR-DB	TP6750R-01-MIR-DB	Delrin	400		
		Crown Mirage (TPR)	TP6750-01-MRC	TP6750R-01-MRC	Roller	400		
		Crown Mirage (TPR)	TP6750-01-MRC-DB	TP6750R-01-MRC-DB	Delrin	400		
		Pro-Tech Polyurethane	TP6750-01-PRO	TP6750R-01-PRO	Roller	600		
		Pro-Tech Polyurethane	TP6750-01-PRO-DB	TP6750R-01-PRO-DB	Delrin	600		
		Plex Solid Polyurethane	TP6750-01-PLX	TP6750R-01-PLX	Roller	800		
		Plex Solid Polyurethane	TP6750-01-PLX-DB	TP6750R-01-PLX-DB	Delrin	800		
		Nylon Glass-Filled	TP6750-01-NGF	TP6750R-01-NGF	Roller	1000		
		Nylon Glass-Filled	TP6750-01-NGF-DB	TP6750R-01-NGF-DB	Delrin	1000		
		Heavy Duty Plastic	TP6750-01-HDP	TP6750R-01-HDP	Roller	550		
		Phenolic	TP6750-01-PHN	TP6750R-01-PHN	Roller	1000		
		Phenolic	TP6750-01-PHN-DB	TP6750R-01-PHN-DB	Delrin	1000		
6	2	Mirage (TPR)	TP6760-01-MIR	TP6760R-01-MIR	Roller	500	7-1/2	4-1/2
		Mirage (TPR)	TP6760-01-MIR-DB	TP6760R-01-MIR-DB	Delrin	500		
		Crown Mirage (TPR)	TP6760-01-MRC	TP6760R-01-MRC	Roller	500		
		Crown Mirage (TPR)	TP6760-01-MRC-DB	TP6760R-01-MRC-DB	Delrin	500		
		Pro-Tech Polyurethane	TP6760-01-PRO	TP6760R-01-PRO	Roller	720		
		Pro-Tech Polyurethane	TP6760-01-PRO-DB	TP6760R-01-PRO-DB	Delrin	720		
		Plex Solid Polyurethane	TP6760-01-PLX	TP6760R-01-PLX	Roller	900		
		Plex Solid Polyurethane	TP6760-01-PLX-DB	TP6760R-01-PLX-DB	Delrin	900		
		Nylon Glass-Filled	TP6760-01-NGF	TP6760R-01-NGF	Roller	1200		
		Nylon Glass-Filled	TP6760-01-NGF-DB	TP6760R-01-NGF-DB	Delrin	1200		
		Heavy Duty Plastic	TP6760-01-HDP	TP6760R-01-HDP	Roller	650		
		Phenolic	TP6760-01-PHN	TP6760R-01-PHN	Roller	1200		
		Phenolic	TP6760-01-PHN-DB	TP6760R-01-PHN-DB	Delrin	1200		
8	2	Mirage (TPR)	TP6780-01-MIR	TP6780R-01-MIR	Roller	600	9-1/2	6-1/2
		Mirage (TPR)	TP6780-01-MIR-DB	TP6780R-01-MIR-DB	Delrin	600		
		Crown Mirage (TPR)	TP6780-01-MRC	TP6780R-01-MRC	Roller	600		
		Crown Mirage (TPR)	TP6780-01-MRC-DB	TP6780R-01-MRC-DB	Delrin	600		
		Pro-Tech Polyurethane	TP6780-01-PRO	TP6780R-01-PRO	Roller	800		
		Pro-Tech Polyurethane	TP6780-01-PRO-DB	TP6780R-01-PRO-DB	Delrin	800		
		Plex Solid Polyurethane	TP6780-01-PLX	TP6780R-01-PLX	Roller	1000		
		Plex Solid Polyurethane	TP6780-01-PLX-DB	TP6780R-01-PLX-DB	Delrin	1000		
		Nylon Glass-Filled	TP6780-01-NGF	TP6780R-01-NGF	Roller	1250		
		Nylon Glass-Filled	TP6780-01-NGF-DB	TP6780R-01-NGF-DB	Delrin	1250		
		Heavy Duty Plastic	TP6780-01-HDP	TP6780R-01-HDP	Roller	850		
		Phenolic	TP6780-01-PHN	TP6780R-01-PHN	Roller	1250		
		Phenolic	TP6780-01-PHN-DB	TP6780R-01-PHN-DB	Delrin	1250		

# Metal Ball Furniture Casters

## TP1000 Series / Capacity up to 90 Lbs.



### Features

- Metal Ball: Made of zinc alloy die cast (not plastic)
- Construction: Styled for home or office use
- Colors: Three popular colors
- Plastic tread protector included
- Multiple Fastenings for different needs

### Applications

- Home and office Equipment
- Furniture
- Store Display Stand Fixtures

### Caster Options

Wheel Diameter	Wheel Type	Swivel Number	Load Capacity	Overall Height
2	Metal Ball	TP1050-**-##	90	2-5/8
2-1/2	Metal Ball	TP1060-**-##		3

Replace -\*\*- in part number with appropriate fastening code.  
 Replace -##- in part number with appropriate finish code.

Options	
CODE	DESCRIPTION
AB	Antique Brass
AC	Antique Copper
BR	Bright Brass
CR	Chrome

Fastening			
TYPE	CODE	SIZE (Inch)	
Top Plate	01	Overall Size	1-1/2 x 1-1/2
		Bolt Hole Spacing	1 x 1
		Attaching Bolt Size	5/16
Grip Ring Stem	11	7/16 x 1	
	12	7/16 x 1-1/2	
Threaded Stem	21	5/16 - 18 x 1	
	23	3/8 - 16 x 1	
Grip Neck Stem	61	5/16 x 1-1/2 (with Wood Socket)	

# Twin Wheel Furniture Casters

## TP1300 Series / Capacity up to 90 Lbs.



### Features

- Nylon twin wheels are easy-rolling and non-marking
- Hood finishes available are Black, Vacuum Chrome, Vacuum Brass, Brushed Chrome, Chrome or Antique Brass
- Hard and Soft wheels are available
- Caster Sockets are available for Grip stem casters

### Applications

- Home and office Equipment
- Furniture
- Store Display Stand Fixtures
- Optional brake available

### Caster Options

- Brake



Wheel Diameter	Wheel Type	Swivel Number	Load Capacity	Overall Height
1-5/8	Nylon	TP1345-**-**	90	2-1/4
2	Nylon	TP1350-**-**		2-5/8
2-3/8	Nylon	TP1360-**-**		3

Replace -\*\*- in part number with appropriate fastening code.

Options	
CODE	DESCRIPTION
BRK	Brake

Fastening			
TYPE	CODE	SIZE (Inch)	
Top Plate	01	Overall Size	1-1/2 x 1-1/2
		Bolt Hole Spacing	1 x 1
		Attaching Bolt Size	5/16
Grip Ring Stem	11	7/16 x 1	
	12	7/16 x 1-1/2	
Threaded Stem	21	5/16 - 18 x 1	
	23	3/8 - 16 x 1	
Grip Neck Stem	61	5/16 x 1-1/2	

TP1000 Series